

# Reel Catalog

Hose, cord and cable reels



[reelcraft.com](http://reelcraft.com)

 **REELCRAFT**<sup>®</sup>  
READY WHEN YOU ARE<sup>®</sup>

## Why use hose reels?

Why use hose reels? Because they make hose handling more efficient and safer. Your hoses, cables and cords will last up to five times longer. You will improve hose management, which decreases labor costs. Your chances of injuries from tripping hazards will decrease, which saves lost work time, medical bills and higher insurance. You also save the expense and time to replace expensive hoses, cables and cords that get run over by fork lifts and other vehicles.

### Five reasons why hose reels add value

- 1. Improve efficiency** - Hoses, cable and cords are where you want and need them
- 2. Increase safety** - Reduce tripping accidents and lost work time
- 3. Minimize leakages** - Reduce costs of air and water leakages
- 4. Reduce hose wear** - Hose and cord on a reel can last up to five times longer
- 5. Increase productivity** - No more tangled hoses improves productivity

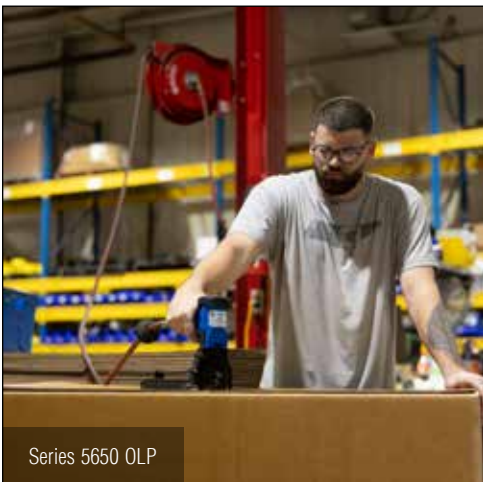
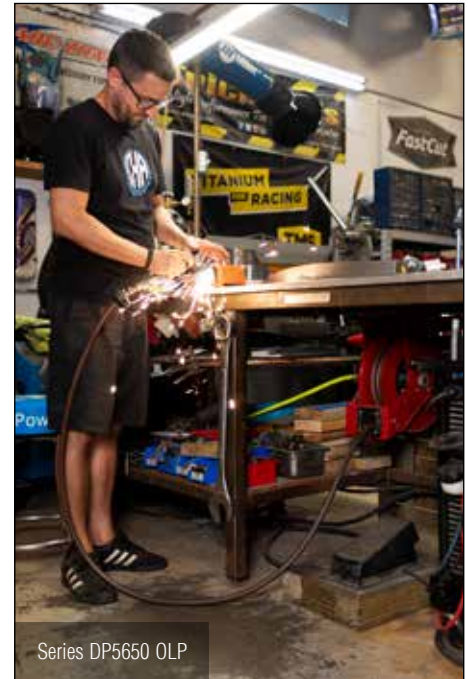

### OSHA says reduce your trips and falls

"There are many situations that may cause slips, trips, and falls. The controls needed to prevent these hazards are usually obvious, but too often ignored, such as...coiling up extension cords, lines, and hoses when not in use and keeping electrical and other wires out of the way." OSHA's "Fall Prevention Tips" include, "Practice good housekeeping. Keep cords, welding leads, and air hoses out of walkways or adjacent work areas."

Source: [osha.gov](https://www.osha.gov)



### Two-Year Limited Warranty and Return Policy

Reelcraft now offers a two-year limited warranty. All reels manufactured by Reelcraft Industries, Inc. are warranted to be free of defects due to faulty material or workmanship for 2 years (6 months for hose and light bulbs) from date of shipment when properly installed, maintained, and operated in accordance with the recommendation of Reelcraft and the manual of instructions. Normal wear and tear is not considered a defect in material or workmanship. For complete warranty information and return information please visit [reelcraft.com](https://reelcraft.com) or call Reelcraft's Customer Service Department toll-free at 1-855-634-9109.

# Reelcraft: Built Better by Design

For over 50 years, Reelcraft has engineered reels for unmatched strength, reliability, and ease of use. Each reel features a durable, corrosion-resistant powder coat finish, multi-position guide arms for flexible mounting, and heavy-duty, reinforced steel stampings for enhanced durability. They're also permanently factory-lubricated for a long, trouble-free service life. Our commitment to excellence is built into every reel we make. That's why our reels are designed, built, and tested to be Ready When You Are®.

### Reinforced Steel

The steel-stamped guide arm is reinforced to reduce bending due to angular pull.

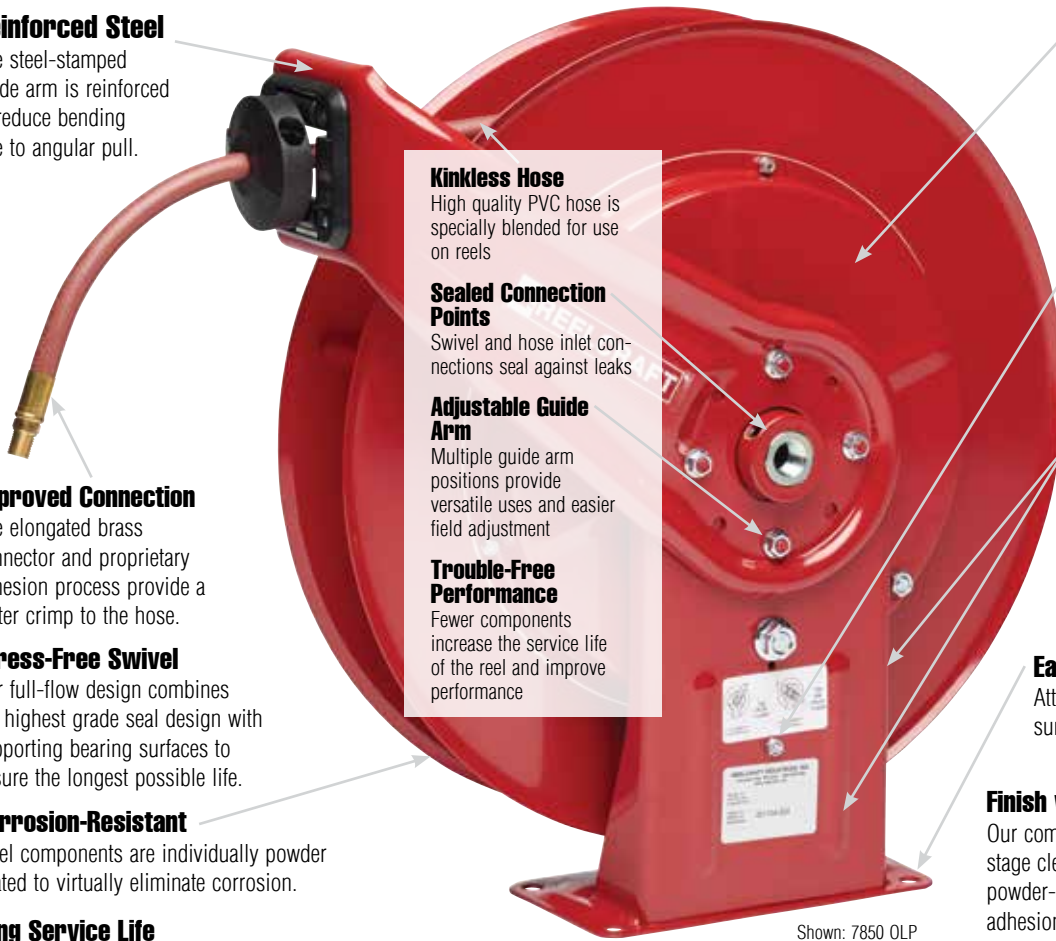

### Kinkless Hose

High quality PVC hose is specially blended for use on reels

### Sealed Connection Points

Swivel and hose inlet connections seal against leaks

### Adjustable Guide Arm

Multiple guide arm positions provide versatile uses and easier field adjustment

### Trouble-Free Performance

Fewer components increase the service life of the reel and improve performance

### Long Life Drive Spring

Drive mechanism is enclosed for protection against the environment. Declutching arbor virtually eliminates possibility of spring damage due to reverse winding of reel spool.

### Robust Latch

Wide profile combined with special spring assures maximum service life.

### Structural Strength

Welded heavy gauge steel frame includes a robotically welded base with stiffening ribs for lighter weight, yet stronger components for ease of handling and installation.

### Easy to Mount

Attaches to most structurally sound surfaces. Edges are curved for safety.

### Finish with Quality

Our components undergo a special five-stage cleaning process and are individually powder-coated for the highest quality paint adhesion. Excess powder is reclaimed to be environmentally friendly.

Shown: 7850 OLP

### Improved Connection

The elongated brass connector and proprietary adhesion process provide a better crimp to the hose.

### Stress-Free Swivel

Our full-flow design combines the highest grade seal design with supporting bearing surfaces to ensure the longest possible life.

### Corrosion-Resistant

Steel components are individually powder coated to virtually eliminate corrosion.

### Long Service Life

Field-proven swivel assures long service life.

### To place an order, please advise:

1. Model number
2. Account number
3. Shipping method

Not a Reelcraft distributor?

Visit our online interactive catalog to find an online or local distributor.

### Additional Considerations:

A flexible connection between the reel and the source of supply is required to prevent possible misalignment and binding. Non-flexible connections will void the warranty. The pressure rating of inlet hose must be equal or greater than the rating of the reel.

**\*Consult Reelcraft for recommendations if installation height is more than 16 feet.**

### Accessories

Reels ordered with hose and bumper are assembled complete and ready to install. Order bumpers separately for reels without hoses.

Additional questions? Please visit our website or call for assistance. For more than 50 years, our specialty is offering hose handling solutions.









### COPYRIGHT NOTICE

All rights reserved. No part of the material protected by this copyright may be reproduced or utilized in any form or by any means, electronic or mechanical, including photocopying, recording, broadcasting or by any other information storage and retrieval system without written permission from Reelcraft Industries, Inc. Reelcraft, Safe-T-Reel, Better by Design, Built Better to Perform Better, Rely on Reelcraft, REELSAFE, and Ready When You Are are the trademarks and service marks of Reelcraft Industries, Inc. registered in the United States and/or other jurisdictions. You shall not display, disparage, dilute or taint our trademarks and service marks, or use our marks in such a way that would misrepresent the identity of the owner. All other trademarks, service marks or registered trademarks appearing on these pages are the trademarks or service marks of their respective owners.



# Table of Contents

Reel Series	Page
<b>Spring Retractable Hose Reels</b>	
<b>Series RT</b> 1/4", 3/8", 1/2" I.D. <b>8</b>	
<b>Series 4000</b> 1/4", 3/8" I.D. <b>8</b>	
<b>Series 5000 &amp; 5005</b> 1/4", 3/8", 1/2" I.D. <b>9</b>	
<b>Series RS7000</b> 1/4", 3/8", 1/2", 3/4" I.D. <b>10</b>	
<b>Enclosed Reels</b> 1/4", 3/8", 1/2" I.D. <b>10</b>	
<b>Series 7000</b> 1/4", 3/8", 1/2", 3/4" I.D. <b>11</b>	
<b>Series HD70000</b> 1/4", 3/8", 1/2" I.D. <b>12</b>	
<b>Series 80000 &amp; D80000</b> 3/8", 1/2", 3/4", 1" I.D. <b>13</b>	
<b>Series DP5000 &amp; DP7000</b> 1/4", 3/8", 1/2" I.D. <b>14</b>	
<b>Series 9000</b> 3/4", 1", 1 1/2" I.D. <b>15</b>	

Reel Series	Page
<b>Specialty Hose Reels</b>	
<b>Fuel Hose Reels</b> 3/4", 1", 1 1/2" I.D. <b>16</b>	
<b>DEF Hose Reels</b> 1/2", 3/4" I.D. <b>17</b>	
<b>Grounding Reels</b> 50 - 100 ft. <b>17</b>	
<b>Twin Hydraulic - Series TH</b> 1/4", 3/8", 1/2" I.D. <b>18</b>	
<b>Pre-Rinse Hose Reels</b> 3/8" I.D. <b>19</b>	
<b>Stainless Steel Fluid Path Reels</b> 1/2", 3/4", 1" I.D. <b>19</b>	
<b>Pressure Wash Reels</b> 1/4", 3/8", 1/2" I.D. <b>20</b>	
<b>Garden Center Reels</b> 1/2", 5/8", 3/4" I.D. <b>21</b>	
<b>Stainless Steel Reels</b> 3/8", 1/2", 3/4", 1" I.D. <b>22</b>	

# Table of Contents

**Reel Series** **Page**

## Hand Crank & Motorized Reels

**Series 30000** Hose reel carts **21**



**Series 20000** 3/8", 1/2", 5/8", 3/4" I.D. **22-23**



**Series C** 3/8", 1/2" I.D. **24**



**Series 30000** 1/2", 3/4", 1" I.D. **24-25**



## Power & Light Cord Reels

**L 4000, L 5000, L 7000 & L 70000** Single, duplex, triple tap, quad receptacle, and flying lead power **26-29**



**Series L 4000** Light cord reels **30**



**Series L NM400** NEMA 4 rated cord reels **30**



**Reel Series** **Page**

## Welding Reels

**Welding Hose Assemblies** Single line and twin line inlet and outlet hose assemblies **31**



**Series SW** Single line welding hose reels **32**



**Series BA & TW** Twin line welding hose reels **33**



**Series CEA & WC** Welding cable reels **34**



**Safe-T-Reels** Multiple configurations **35**



## Tool Balancers

**Series TB & TBL & Bumper Stops** Tool balancers and bumper stops **36**



## Parts & Accessories

**Hose Assemblies** 1/4", 3/8", 1/2", 3/4", 1" I.D. **37**



**Rewind Motor, Switches, & Kits** Motor accessories, Series 9000 hose guide conversion kits, stacking bracket kits **38**



**Mounting Accessories** Hose guides, roller guides, bases, and brackets **39**



## Display Stand

**Six Reel Display** S602037-2

Conveniently displays up to six reels and features removable universal brackets for ease of mounting. The stand is made from extruded aluminum and the brackets are fabricated from high-grade industrial steel. Reels sold separately.

## Reelcraft's Online Interactive Catalog

### Complete Online Catalog of Products

Reelcraft's interactive catalog gives users the ability to self-select the product they need for their specific application. The products are grouped into categories by application and gives the user the choice to narrow their search by filters such as hose/cord length, drive type, reel grade, etc. The individual product pages include all the available information for each product including:

- Product specs and dimensions
- Tech bulletins
- Available parts and accessories
- Distributor locator
- Videos
- 360° images
- Service manuals
- CAD drawings
- FAQs

### Parts and Accessories

The interactive catalog also contains an extensive listing of parts and accessories. Search the catalog for hose assemblies by hose I.D., length, pressure rating, or end fitting size. The catalog also contains information for the following items:

- Replacement hose assemblies
- Bumper stop assemblies
- Swivel assemblies
- Inlet hose assemblies
- Roller guide assemblies
- Motors and motor accessories
- Swing brackets
- Pivot bases

Visit [reelcraft.com/catalog](http://reelcraft.com/catalog) to start your search!



## Easy to use!



## Spring Retractable Reels Model Number Chart

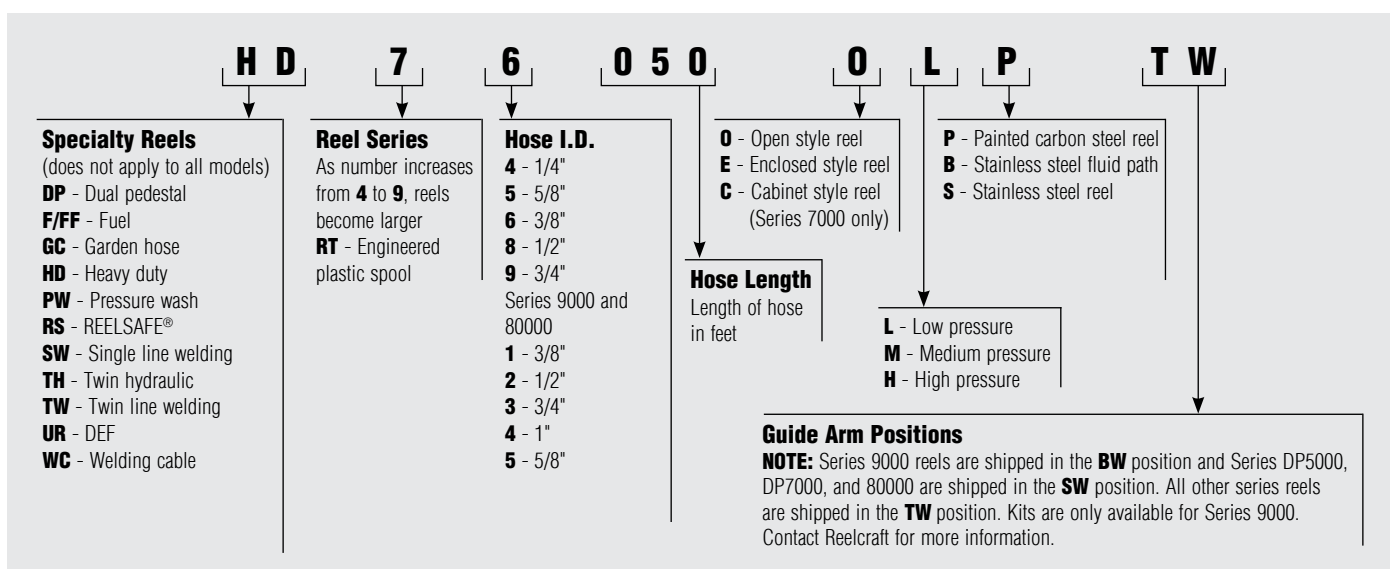

Some model series include a revision letter prefix, does not apply to all series. Chart is for reference only.  
Not all options available in every combination. Reels cannot be ordered by selecting from this chart.

## Powder Coat Paint Colors

### Customize your reel paint color

Reelcraft is most well-known for its bright red reels, but we also powder coat paint black and white. Other specialty colors are also available, consult Reelcraft for more information.

\*Minimum quantities may apply



## Reel Accessories

A wide range of available accessories for your reel including inlet hoses, motor switches, hose roller guides, swing brackets, and swivel bases.

**See page 37-39 for reel accessories or visit [reelcraft.com/accessories](http://reelcraft.com/accessories) for a complete list.**



**Swing bracket**  
600993



**Push button switch**  
600811



**Inlet hose**  
S600982-10

## Reel Replacement Parts and Kits

Many parts of a Reelcraft reel can be easily serviced and/or replaced. Visit [reelcraft.com/service-manuals](http://reelcraft.com/service-manuals) for a complete list of product service manuals.

**For outlet hose assemblies, drive motors, swivel assemblies, and adjustable bumpers, visit [reelcraft.com/accessories](http://reelcraft.com/accessories).**



**Adjustable bumper**  
S1-HR1004-3

**Swivel assembly**  
S600300-1



**Hose assembly**  
S601035-75

## Guide Arm Positions

Series 9000 reels are shipped in the **BW** position and Series DP5000, DP7000, and 80000 are shipped in the **SW** position. All other series reels are shipped in the **TW** position. Kits are available for alternate guide arm positions. Contact Reelcraft for more information.

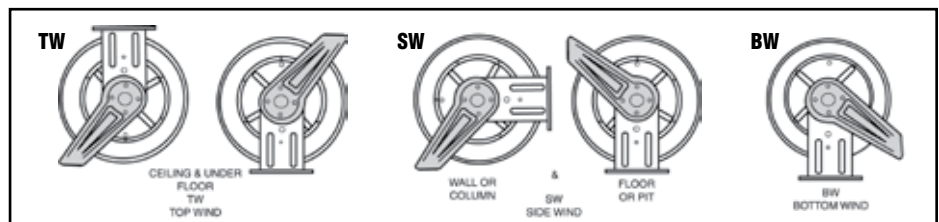



## Medium Duty Spring Retractable Reels



**Air/Water** - 1/4", 3/8", 1/2" I.D.

- Spool is constructed from a rugged engineered plastic
- The steel guide arm and base are stamped with ribs and gussets to ensure maximum strength and lightest possible weight
- Guide arm adjusts to seven positions
- Widened ratchet and latch pawl design greatly reduces wear and increases service life
- The industrial-grade drive spring completely containerized and permanently sealed



RT650-OLP

Model with hose & bumper	Shipping Weight		Hose I.D.		Hose O.D.		Hose Length		Max Pressure		NPT(M) Hose Outlet	NPT(F) Reel Inlet	NPT(F) Reel Outlet	Size Index #
	lbs	kg	in	mm	in	mm	ft	m	psi	bar	in	in	in	
Low Pressure Air/Water Reels    Maximum Temperature 150°F (65°C)    Max working pressure is at 70°F (20°C)														
RT435-OLP	20	9	1/4	6	.475	12	35	11	300	21	1/4	3/8	1/4	1
RT450-OLP	24	11	1/4	6	.475	12	50	15	300	21	1/4	1/2	1/4	1
RT650-OLP	27	12	3/8	10	.600	15	50	15	300	21	1/4	1/2	1/4	1
RT835-OLP	27	12	1/2	13	.750	19	35	11	300	21	1/2	1/2	1/2	1
RT850-OLP	37	17	1/2	13	.750	19	50	15	300	21	1/2	1/2	1/2	2

Reels supplied with PVC hose.

Model without hose & bumper	Shipping Weight		Hose Capacity						Max Pressure		NPT(F) Reel Inlet	NPT(F) Reel Outlet	Size Index #
			I.D.		O.D.		Length						
	lbs	kg	in	mm	in	mm	ft	m	psi	bar	in	in	
Low Pressure Air/Water Reels			Maximum Temperature 210°F (99°C)										
RT405-OLP	21	10	1/4	6	.475	12	50	15	300	21	1/2	1/4	1
RT605-OLP	22	10	3/8	10	.600	15	50	15	300	21	1/2	1/4	1
RT802-OLP	27	12	1/2	13	.750	19	35	11	300	21	1/2	1/2	1
RT805-OLP	25	11	1/2	13	.750	19	50	15	300	21	1/2	1/2	2

	Dimensions			Dimensions	
	1	2		1	2
	in	mm		in	mm
<b>A</b>	17 <sup>7</sup> / <sub>8</sub>	454	<b>A</b>	17 <sup>7</sup> / <sub>8</sub>	454
<b>B</b>	16 <sup>1</sup> / <sub>2</sub>	419	<b>B</b>	16 <sup>1</sup> / <sub>2</sub>	419
<b>C</b>	6	152	<b>C</b>	6	152
<b>D</b>	2 <sup>1</sup> / <sub>4</sub>	57	<b>D</b>	2 <sup>1</sup> / <sub>4</sub>	57
<b>E</b>	6 <sup>1</sup> / <sub>4</sub>	159	<b>E</b>	7 <sup>3</sup> / <sub>4</sub>	197

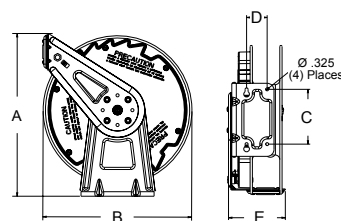

## Premium Duty Spring Retractable Reels



**Series 4000 - Air/Water** - 1/4", 3/8" I.D.

- Compact for a wide range of applications with critical space requirements
- Inlet hose is plumbed into the base to eliminate the risk of stress on the swivel
- Guide arm adjusts to two positions
- The reliable speed latch allows for positive locking of the spool in two positions per rotation



4625 OLP

Series 4000 reels include a speed latch mechanism that uses a cam and disc for quiet operation.

Model with hose & bumper	Shipping Weight		Hose I.D.		Hose O.D.		Hose Length		*Max Pressure	NPT(M) Hose Outlet	NPT(F) Reel Inlet	NPT(F) Reel Outlet
	lbs	kg	in	mm	in	mm	ft	m	psi	bar	in	in
<b>Low Pressure Air/Water Reels</b> Maximum Temperature 150°F (65°C)												
4435 OLP	19	9	1/4	6	.475	12	35	11	300	21	1/4	3/8
4625 OLP	20	9	3/8	10	.600	15	25	8	300	21	1/4	3/8

Low pressure reels supplied with PVC hose. \*Maximum working pressure at 70°F (20°C)

Model without hose & bumper	Shipping Weight		Hose Capacity						Max Pressure		NPT(F) Reel Inlet	NPT(F) Reel Outlet
			I.D.		O.D.		Length					
	lbs	kg	in	mm	in	mm	ft	m	psi	bar	in	in
Low Pressure Air/Water Reels			Maximum Temperature 210°F (99°C)									
4400 OLP	17	8	1/4	6	.475	12	35	11	500	35	3/8	1/4
4600 OLP	17	8	3/8	10	.600	15	25	8	500	35	3/8	1/4

	Dimensions	
	in	mm
<b>A</b>	12 <sup>7</sup> / <sub>8</sub>	327
<b>B</b>	12 <sup>5</sup> / <sub>8</sub>	321
<b>C</b>	8	203
<b>D</b>	2 <sup>1</sup> / <sub>2</sub>	64
<b>E</b>	5 <sup>5</sup> / <sub>8</sub>	143

### Additional Series 4000 Models

**Cord Reels** - Page 27-30



## Premium Duty Spring Retractable Reels

**Air/Water/Oil/Grease** - 1/4", 3/8", 1/2" I.D.

- Compact for a wide range of applications with critical space requirements
- Robotically welded steel base offers maximum strength and consistent quality
- Individually powder-coated steel components provide maximum protection from premature corrosion
- Guide arm adjusts to two positions
- Inlet hose is plumbed into the base to eliminate the risk of stress on the swivel
- The reliable speed latch allows for positive locking of the spool in two positions per rotation
- The swivel is nested inside the spool for protection from impact and the environment



### Additional Series 5000 / 5005 Models

**Enclosed Reels** - Page 10

**Pre-Rinse** - Page 19

**Gas Welding** - Pages 32-33

**Twin Hydraulic** - Page 18

**Cord Reels** - Page 26-29



5635 OLP



5650 OLP

Model with hose & bumper	Shipping Weight		Hose I.D.		Hose O.D.		Hose Length		Max Pressure		NPT(M) Hose Outlet	NPT(F) Reel Inlet	NPT(F) Reel Outlet	Size Index #
	lbs	kg	in	mm	in	mm	ft	m	psi	bar	in	in	in	
Low Pressure Air/Water Reels    Maximum Temperature 150°F (65°C)    Max working pressure is at 70°F (20°C)														
5450 OLP	26	12	1/4	6	.475	12	50	15	300	21	1/4	3/8	1/4	1
5635 OLP	25	11	3/8	10	.600	15	35	11	300	21	1/4	3/8	1/4	1
5650 OLP	36	16	3/8	10	.600	15	50	15	300	21	1/4	3/8	1/4	2
A5825 OLP	27	12	1/2	13	.750	19	25	8	300	21	1/2	3/8	1/2	1
A5835 OLP	39	18	1/2	13	.750	19	35	11	300	21	3/8	3/8	1/2	2
A5850 OLP	41	19	1/2	13	.750	19	50	15	300	21	1/2	3/8	1/2	3
Medium Pressure Oil Reels    Maximum Temperature 210°F (99°C)														
5630 OMP	31	14	3/8	10	.690	18	30	9	2600	179	3/8	3/8	3/8	1
A5835 OMP	42	19	1/2	13	.820	21	35	11	3000	207	1/2	3/8	1/2	2
Low pressure reels supplied with PVC hose. Medium pressure reels supplied with S.A.E. 100R1-AT (3/8") or S.A.E. 100R17 (1/2") one wire braid hose.														

Low pressure reels supplied with PVC hose. Medium pressure reels supplied with S.A.E. 100R1-AT (3/8") or S.A.E. 100R17 (1/2") one wire braid hose.

Model without hose & bumper	Shipping Weight		Hose Capacity						Max Pressure		NPT(F) Reel Inlet	NPT(F) Reel Outlet	Size Index #
			I.D.		O.D.		Length						
	lbs	kg	in	mm	in	mm	ft	m	psi	bar	in	in	
Low Pressure Air/Water Reels			Maximum Temperature 210°F (99°C)										
5400 OLP	20	9	1/4	6	.475	12	50	15	500	35	3/8	1/4	1
5600 OLP	21	10	3/8	10	.600	15	35	11	500	35	3/8	1/4	1
5605 OLP	21	10	3/8	10	.600	15	50	15	500	35	3/8	1/4	2
A5800 OLP	22	10	1/2	13	.750	19	25	8	500	35	3/8	1/2	1
A5806 OLP	35	16	1/2	13	.750	19	50	15	500	35	3/8	1/2	3
Medium Pressure Oil Reels			Maximum Temperature 210°F (99°C)										
5400 OMP	23	10	1/4	6	.530	13	35	11	3000	207	3/8	3/8	1
5600 OMP	24	11	3/8	10	.690	18	30	9	3000	207	3/8	3/8	1
High Pressure Grease Reels			Maximum Temperature 210°F (99°C)										
5400 OHP	23	10	1/4	6	.580	15	30	9	5000	345	1/4	1/4	1

Dimensions						
	1		2		3	
	in	mm	in	mm	in	mm
<b>A</b>	14 <sup>3</sup> / <sub>8</sub>	365	17 <sup>5</sup> / <sub>8</sub>	448	17 <sup>5</sup> / <sub>8</sub>	448
<b>B</b>	13 <sup>3</sup> / <sub>4</sub>	349	16 <sup>3</sup> / <sub>4</sub>	425	16 <sup>3</sup> / <sub>4</sub>	425
<b>C</b>	9 <sup>3</sup> / <sub>4</sub>	248	9 <sup>3</sup> / <sub>4</sub>	248	9 <sup>3</sup> / <sub>4</sub>	248
<b>D</b>	2 <sup>1</sup> / <sub>2</sub>	64	2 <sup>1</sup> / <sub>2</sub>	64	2 <sup>1</sup> / <sub>2</sub>	64
<b>E</b>	6 <sup>1</sup> / <sub>8</sub>	156	5 <sup>7</sup> / <sub>8</sub>	149	7 <sup>1</sup> / <sub>4</sub>	184

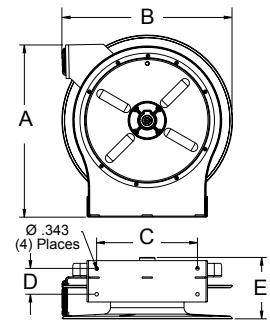

**Interactive Reel Catalog**

Visit [reelcraft.com/catalog](http://reelcraft.com/catalog) for complete product specifications, available parts, and accessories.



**Pivot Bases & Swing Brackets**  
See page 39

## Premium Duty Spring Retractable Hose Reels



**Air/Water/Oil/Grease** - 1/4", 3/8", 1/2", 3/4" I.D.

- Retracts at the average human walking speed of 2 to 3 MPH
- Integral clutch creates a consistent retraction speed regardless of fluid or environmental temperatures
- Safely protects personnel and equipment



RS7650 OLP

Model with hose & bumper	Shipping Weight		Hose I.D.		Hose O.D.		Hose Length		Max Pressure		NPT(M) Hose Outlet	NPT(F) Reel Inlet	NPT(F) Reel Outlet
	lbs	kg	in	mm	in	mm	ft	m	psi	bar	in	in	in
<b>Low Pressure Air/Water Reels</b> Maximum Temperature 150°F (65°C) Max working pressure is at 70°F (20°C)													
RS7650 OLP	46	21	3/8	10	.600	15	50	15	300	21	1/4	1/2	1/2
RS7670 OLP	50	23	3/8	10	.600	15	70	22	300	21	1/4	1/2	1/2
RS7850 OLP	50	23	1/2	13	.750	19	50	15	300	21	3/8	1/2	1/2
RS7925 OLP	50	23	3/4	19	1.075	27	25	8	250	17	3/4	3/4	3/4
<b>Medium Pressure Oil Reels</b> Maximum Temperature 210°F (99°C)													
RS7650 OMP	58	26	3/8	10	.690	18	50	15	2600	179	3/8	1/2	1/2
RS7850 OMP	60	27	1/2	13	.820	21	50	15	3000	207	1/2	1/2	1/2
<b>High Pressure Grease Reels</b> Maximum Temperature 210°F (99°C)													
RS7450 OHP	58	26	1/4	6	.580	15	50	15	5000	345	1/4	1/2	1/2
RS7650 OHP	63	29	3/8	10	.730	19	50	15	4800	331	1/4	1/2	1/2

Low pressure reels supplied with PVC hose. Medium pressure reels supplied with S.A.E. 100R1-AT (3/8") or S.A.E. 100R17 (1/2") one wire braid hose. High pressure reels supplied with S.A.E. 100 R2T two wire braid hose.

**Controlled  
Return Hose Reel**



Dimensions					
	A	B	C	D	E
in	20 <sup>1</sup> / <sub>4</sub>	19 <sup>3</sup> / <sub>4</sub>	7 <sup>13</sup> / <sub>16</sub>	3 <sup>7</sup> / <sub>8</sub>	7
mm	514	502	198	98	178

Model without hose & bumper	Shipping Weight		Hose Capacity			Max Pressure		NPT(F) Reel Inlet	NPT(F) Reel Outlet
	lbs	kg	I.D.	O.D.	Length	psi	bar	in	in
<b>Low Pressure Air/Water Reels</b> Maximum Temperature 210°F (99°C)									
RS7600 OLP	43	20	3/8	10	.600	16	50	15	1/2
RS7800 OLP	44	20	1/2	13	.750	19	50	15	1/2
<b>Medium Pressure Oil Reels</b> Maximum Temperature 210°F (99°C)									
RS7600 OMP	46	21	3/8	10	.690	18	50	15	1/2
<b>High Pressure Grease Reels</b> Maximum Temperature 210°F (99°C)									
RS7400 OHP	46	21	1/4	6	.580	15	50	15	1/2
RS7600 OHP	49	27	3/8	10	.730	19	50	15	1/2



**Pivot Bases & Swing Brackets**  
See page 39

## Premium Duty Enclosed Hose Reels

**Air/Water** - 1/4", 3/8", 1/2" I.D.

- Features a steel enclosure that offers an additional level of protection for the hose
- Remove the cover on either side for easy access

5450 ELP



Model with hose & bumper	Shipping Weight		Hose I.D.		Hose O.D.		Hose Length		Max Pressure		NPT(M) Hose Outlet	NPT(F) Reel Inlet	NPT(F) Reel Outlet	Size Index #
	lbs	kg	in	mm	in	mm	ft	m	psi	bar	in	in	in	
Low Pressure Air/Water Reels    Maximum Temperature 150°F (65°C)    Max working pressure is 70°F (20°C)														
5450 ELP	37	17	1/4	6	.475	12	50	15	300	21	1/4	3/8	1/4	1
7650 ELP	63	29	3/8	10	.600	15	50	15	300	21	1/4	1/2	1/2	2
7670 ELP	68	31	3/8	10	.600	15	70	22	300	21	1/4	1/2	1/2	2
7850 ELP	74	34	1/2	13	.750	19	50	15	300	21	3/8	1/2	1/2	2

	1		2	
	in	mm	in	mm
<b>A</b>	15	381	20 <sup>7</sup> / <sub>8</sub>	530
<b>B</b>	16 <sup>1</sup> / <sub>4</sub>	413	21 <sup>1</sup> / <sub>8</sub>	537
<b>C</b>	9 <sup>3</sup> / <sub>4</sub>	248	7 <sup>13</sup> / <sub>16</sub>	198
<b>D</b>	2 <sup>1</sup> / <sub>2</sub>	64	3 <sup>7</sup> / <sub>8</sub>	98
<b>E</b>	7	178	7 <sup>5</sup> / <sub>8</sub>	194

## Premium Duty Spring Retractable Hose Reels

**Air/Water/Oil/Grease** - 1/4", 3/8", 1/2", 3/4" I.D.

- Robust and ideal for the most demanding applications
- Individually powder-coated steel components provide maximum protection from premature corrosion
- Base plate, upright, and guide arm are constructed from 11 gauge steel; the spool is 16 gauge steel
- Inlet hose is plumbed into the base to eliminate the risk of stress on the swivel
- Guide arm adjusts to seven positions
- Full flow swivel combines the highest grade seal design and materials with bearing areas for maximum service life



7650 OLP



### Additional Series 7000 Models

- Enclosed Reels** - Page 10
- Fuel/DEF** - Pages 16-17
- Twin Hydraulic** - Page 18
- Pressure Wash** - Page 20
- Garden Reels** - Page 21
- Stainless Steel** - Page 22
- Cord Reels** - Page 28
- Gas/Cable Welding** - Pages 32-34



7600 OLP



7850 CLP



7650 OLP

Model with hose & bumper	Shipping Weight		Hose I.D.		Hose O.D.		Hose Length		Max Pressure		NPT(M) Hose Outlet	NPT(F) Reel Inlet	NPT(F) Reel Outlet
	lbs	kg	in	mm	in	mm	ft	m	psi	bar	in	in	in
<b>Low Pressure Air/Water Reels</b> Maximum Temperature 150°F (65°C) Max working pressure is at 70°F (20°C)													
7650 OLP	43	20	3/8	10	.600	15	50	15	300	21	1/4	1/2	1/2
7670 OLP	47	21	3/8	10	.600	15	70	22	300	21	1/4	1/2	1/2
7850 OLP	47	21	1/2	13	.750	19	50	15	300	21	3/8	1/2	1/2
7850 CLP*	45	21	1/2	13	.750	19	50	15	300	21	3/8	1/2	1/2
7850 OLP121	47	21	1/2	13	.750	19	50	15	300	21	1/2	1/2	1/2
7925 OLP	47	21	3/4	19	1.075	27	25	8	250	17	3/4	3/4	3/4
<b>Medium Pressure Oil Reels</b> Maximum Temperature 210°F (99°C)													
7650 OMP	55	25	3/8	10	.690	18	50	15	2600	179	3/8	1/2	1/2
7850 OMP	57	26	1/2	13	.820	21	50	15	3000	207	1/2	1/2	1/2
<b>High Pressure Grease Reels</b> Maximum Temperature 210°F (99°C)													
7450 OHP	55	25	1/4	6	.580	15	50	15	5000	345	1/4	1/2	3/8
7650 OHP	60	27	3/8	10	.730	19	50	15	4800	331	1/4	1/2	3/8

Low pressure reels supplied with PVC hose. Medium pressure reels supplied with S.A.E. 100R1-AT (3/8") or S.A.E. 100R17 (1/2") one wire braid hose. High pressure reels supplied with S.A.E. 100 R2T two wire braid hose. \*Cabinet style reel - guide arm not included; inlet hose is included

Dimensions					
	A	B	C	D	E
in	20 1/4	19 3/4	7 13/16	3 7/8	7
mm	514	502	198	98	178

**Meets or exceeds military vibration for Truck Transport test**

MIL-STD-810F  
500,000 mile equivalent

Model without hose & bumper	Shipping Weight		Hose Capacity			Max Pressure		NPT(F) Reel Inlet	NPT(F) Reel Outlet
	lbs	kg	I.D.	O.D.	Length	psi	bar	in	in
			in	mm	ft				
<b>Low Pressure Air/Water Reels</b> Maximum Temperature 210°F (99°C)									
7600 OLP	40	18	3/8	10	.600	15	70	22	500 35 1/2 1/2
7800 OLP	41	19	1/2	13	.750	19	50	15	500 35 1/2 1/2
7900 OLP	44	20	3/4	19	1.075	27	25	8	500 35 3/4 3/4
<b>Medium Pressure Oil Reels</b> Maximum Temperature 210°F (99°C)									
7600 OMP	43	20	3/8	10	.690	18	50	15	3000 207 1/2 1/2
7800 OMP	43	20	1/2	13	.820	21	50	15	3000 207 1/2 1/2
<b>High Pressure Grease Reels</b> Maximum Temperature 210°F (99°C)									
7400 OHP	43	20	1/4	6	.580	15	50	15	5000 345 1/2 3/8
7600 OHP	46	21	3/8	10	.730	19	50	15	5000 345 1/2 3/8



**Interactive Reel Catalog**

Visit [reelcraft.com/catalog](http://reelcraft.com/catalog) for complete product specifications, parts, and accessories.



**Pivot Bases & Swing Brackets**  
See page 39

## Heavy Duty Spring Retractable Hose Reels

**Air/Water/Oil/Grease** - 1/4", 3/8", 1/2" I.D.

- Compact design - reels are 25% smaller than our Series 80000 reels
- Redesigned latching mechanism provides longer service life of the latch components
- Guide arm adjusts to seven positions
- The one-piece guide roller design and stainless steel pins offer greater strength and easier serviceability
- Containerized drive spring offers easier handling during maintenance (size index 2 models only)
- High quality, die-cast aluminum hub and two sealed ball bearings produce a smoother spool rotation and easier operation
- Heavy duty, 7 gauge all-steel base and baked-on powder coat finish produce a rugged, corrosion-resistant reel



HD76100 OLP

**Meets or exceeds military vibration for Truck Transport test**

MIL-STD-810F  
500,000 mile equivalent



HD78005 OLP



### Additional Series HD70000 Models

**S.S. Fluid Path** - Page 19

**Cord Reels** - Pages 26-29

**Gas Welding** - Pages 32-33

Model with hose & bumper	Shipping Weight		Hose I.D.		Hose O.D.		Hose Length		Max Pressure		NPT(M) Hose Outlet	NPT(F) Reel Inlet	NPT(F) Reel Outlet	Size Index #
	lbs	kg	in	mm	in	mm	ft	m	psi	bar	in	in	in	
<b>Low Pressure Air/Water Reels</b> Maximum Temperature 150°F (65°C) Max working pressure is at 70°F (20°C)														
HD76050 OLP	45	20	3/8	10	.600	15	50	15	300	21	1/4	1/2	1/2	1
HD76070 OLP	49	22	3/8	10	.600	15	70	21	300	21	1/4	1/2	1/2	1
HD76075 OLP	59	27	3/8	10	.600	15	75	23	300	21	1/4	1/2	1/2	2
HD76100 OLP	75	34	3/8	10	.600	15	100	30	300	21	1/4	1/2	1/2	2
HD78050 OLP	49	22	1/2	13	.750	19	50	15	300	21	3/8	1/2	1/2	1
HD78075 OLP	73	33	1/2	13	.750	19	75	23	300	21	3/8	1/2	1/2	2
<b>Medium Pressure Oil Reels</b> Maximum Temperature 210°F (99°C)														
HD76075 OMP	85	39	3/8	10	.690	18	75	23	2600	179	3/8	1/2	1/2	1
HD78050 OMP	59	27	1/2	13	.820	21	50	15	3000	207	1/2	1/2	1/2	1
HD78065 OMP	78	35	1/2	13	.820	21	65	20	3000	207	1/2	1/2	1/2	2
<b>High Pressure Grease Reels</b> Maximum Temperature 210°F (99°C)														
HD74075 OHP	80	36	1/4	6	.580	15	75	23	5000	345	1/4	1/2	3/8	2
HD74100 OHP	86	39	1/4	6	.580	15	100	30	5000	345	1/4	1/2	3/8	2
HD76075 OHP	90	41	3/8	10	.730	19	75	23	4800	331	1/4	1/2	3/8	2
Low pressure reels supplied with PVC hose. Medium pressure reels supplied with S.A.E. 100R1-AT (3/8") or S.A.E. 100R17 (1/2") one wire braid hose. High pressure reels supplied with S.A.E. 100 B2T two wire braid hose.														

Low pressure reels supplied with PVC hose. Medium pressure reels supplied with S.A.E. 100R1-AT (3/8") or S.A.E. 100R17 (1/2") one wire braid hose. High pressure reels supplied with S.A.E. 100 R2T two wire braid hose.

Model without hose & bumper	Shipping Weight		Hose Capacity			Max Pressure	NPT(F) Reel Inlet	NPT(F) Reel Outlet	Size Index #
	lbs	kg	I.D.	O.D.	Length				
			in	mm	ft	m	psi	bar	
<b>Low Pressure Air/Water Reels</b> Maximum Temperature 210°F (99°C)									
HD76005 OLP	56	25	3/8	10	.600	15	100	30	500 35 1/2 1/2 2
HD78005 OLP	58	26	1/2	13	.750	19	75	23	500 35 1/2 1/2 2

Dimensions - Size Index				
	1		2	
	in	mm	in	mm
<b>A</b>	20 1/4	514	20 1/4	514
<b>B</b>	19 3/4	502	19 3/4	502
<b>C</b>	7 13/16	198	7 13/16	198
<b>D</b>	3 7/8	98	3 7/8	98
<b>E</b>	7	178	8 1/2	216

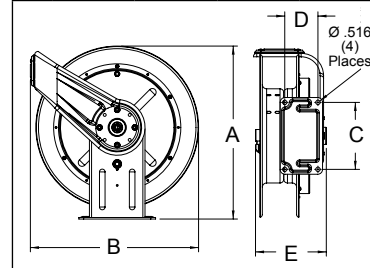

**Interactive Reel Catalog**

Visit [reelcraft.com/catalog](http://reelcraft.com/catalog) for complete product specifications, parts, and accessories.



**Pivot Bases & Swing Brackets**  
See page 39



## Ultimate Duty Spring Retractable Reels



**Air/Water/Oil/Grease** - 3/8", 1/2", 3/4", 1" I.D.

- Robust, dual pedestal base mounts to any load-bearing surface – built for maximum durability and offers performance and longevity in the harshest conditions
- Five-in-one, heat treated aluminum casting saves space and eliminates leaks
- Up to four guide arm locations
- Two sealed ball bearings for smooth rotation of the main shaft
- Versatile reel inlet can be connected to the fluid source on the right or left side
- Base plate constructed from 7 gauge steel, upright and guide arm are 11 gauge steel, and the spool is 16 gauge steel



82100 OLP

### Additional Series 80000 / D80000 Models

**Fuel/DEF** - Pages 16-17

**Pressure Wash** - Page 20

**Stainless Steel** - Page 22

**Twin Hydraulic** - Page 18

**Garden Reels** - Page 21

**Gas/Cable Welding** - Pages 32-34

**Meets or exceeds military vibration for Truck Transport test MIL-STD-810F 500,000 mile equivalent**

Model with hose & bumper	Shipping Weight		Hose I.D.		Hose O.D.		Hose Length		Max Pressure		NPT(M) Hose Outlet	NPT(F) Reel Inlet	NPT(F) Reel Outlet	Size Index #
	lbs	kg	in	mm	in	mm	ft	m	psi	bar	in	in	in	
Low Pressure Air/Water Reels      Maximum Temperature 150°F (65°C)      Max working pressure is at 70°F (20°C)														
81075 OLP	76	34	3/8	10	.600	15	75	23	300	21	3/8	1/2	1/2	1
81100 OLP	92	42	3/8	10	.600	15	100	30	300	21	3/8	1/2	1/2	1
82100 OLP	97	44	1/2	13	.750	19	100	30	300	21	1/2	1/2	1/2	1
83050 OLP	90	41	3/4	19	1.075	27	50	15	250	17	3/4	3/4	3/4	1
D83075 OLP	102	46	3/4	19	1.075	27	75	23	250	17	3/4	3/4	3/4	2
D84050 OLP	103	47	1	25	1.375	35	50	15	250	17	3/4	1	1	3
Medium Pressure Oil Reels      Maximum Temperature 210°F (99°C)														
82075 OMP	101	46	1/2	13	.850	22	75	23	2000	138	1/2	1/2	1/2	1
82100 OMP	109	49	1/2	13	.850	22	100	30	3000	207	1/2	1/2	1/2	1
83050 OMP	98	44	3/4	19	1.188	30	50	15	1250	86	3/4	3/4	3/4	1
D84050 OMP	122	55	1	25	1.400	36	50	15	1275	88	1	1	1	3
High Pressure Grease Reels      Maximum Temperature 210°F (99°C)														
81100 OHP	127	58	3/8	10	.730	19	100	30	4800	331	3/8	3/8	3/8	1
Low pressure reels supplied with PVC hose. Medium pressure reels supplied with S.A.E. 100R17 (1/2") or S.A.E. 100R1 (3/4" and 1") one wire braid hose. High pressure reels supplied with S.A.E. 100 R2T two wire braid hose.														

Low pressure reels supplied with PVC hose. Medium pressure reels supplied with S.A.E. 100R17 (1/2") or S.A.E. 100R1 (3/4" and 1") one wire braid hose. High pressure reels supplied with S.A.E. 100 R2T two wire braid hose.

Model without hose & bumper	Shipping Weight		Hose Capacity						Max Pressure		NPT(F) Reel Inlet	NPT(F) Reel Outlet	Size Index #
			I.D.		O.D.		Length						
	lbs	kg	in	mm	in	mm	ft	m	psi	bar	in	in	
Low Pressure Air/Water Reels			Maximum Temperature 210°F (99°C)										
81000 OLP	82	37	3/8	10	.600	15	100	30	500	35	1/2	1/2	1
82000 OLP	82	37	1/2	13	.750	19	100	30	500	35	1/2	1/2	1
83000 OLP	74	34	3/4	19	1.075	27	50	15	500	35	3/4	3/4	1
D83000 OLP	85	39	3/4	19	1.075	27	75	23	500	35	3/4	3/4	2
D84000 OLP	84	38	1	25	1.375	35	50	15	500	35	1	1	3
Medium Pressure Oil Reels			Maximum Temperature 210°F (99°C)										
82000 OMP	82	37	1/2	13	.850	22	100	30	3000	207	1/2	1/2	1
83000 OMP	84	38	3/4	19	1.188	30	50	15	1500	103	3/4	3/4	1
D84000 OMP	85	39	1	25	1.400	36	50	15	1500	103	1	1	1
High Pressure Grease Reels			Maximum Temperature 210°F (99°C)										
81000 OHP	85	39	3/8	10	.730	19	100	30	5000	345	3/8	3/8	1

Dimensions - Size Index						
	1		2		3	
	in	mm	in	mm	in	mm
<b>A</b>	25 <sup>3</sup> / <sub>8</sub>	645	25 <sup>3</sup> / <sub>8</sub>	645	25 <sup>3</sup> / <sub>8</sub>	645
<b>B</b>	24	610	24	610	24	610
<b>C</b>	10	254	10 <sup>1</sup> / <sub>2</sub>	267	10 <sup>1</sup> / <sub>2</sub>	267
<b>D</b>	6	152	7 <sup>7</sup> / <sub>8</sub>	200	7 <sup>7</sup> / <sub>8</sub>	200
<b>E</b>	10 <sup>1</sup> / <sub>2</sub>	267	13	330	15 <sup>3</sup> / <sub>4</sub>	400
<b>F</b>	8 <sup>1</sup> / <sub>8</sub>	206	10 <sup>3</sup> / <sub>8</sub>	264	10 <sup>3</sup> / <sub>8</sub>	264

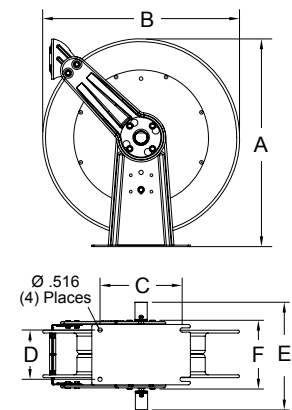

**Interactive Reel Catalog**

Visit [reelcraft.com/catalog](http://reelcraft.com/catalog) for complete product specifications, parts, and accessories.



**Pivot Bases & Swing Brackets**  
See page 39

## Ultimate Duty Spring Retractable Hose Reels

**Air/Water/Oil/Grease** - 1/4", 3/8", 1/2" I.D.

- Features an innovative, non-welded, interlocking base that increases the strength while utilizing fewer parts
- Independent testing to military standards has proven the reels stand up to heavy vibration, which makes them especially strong and ideal for truck-mounted applications
- Superbly engineered dual pedestal base and guide arm are structurally reinforced
- Torsion style latch spring life far exceeds that of conventional coil springs



		Dimensions - Size Index							
		1		2		3		4	
		in	mm	in	mm	in	mm	in	mm
	A	16 <sup>3</sup> / <sub>8</sub>	416	16 <sup>3</sup> / <sub>8</sub>	416	17	432	17	432
	B	14 <sup>3</sup> / <sub>8</sub>	365	14 <sup>3</sup> / <sub>8</sub>	365	16 <sup>1</sup> / <sub>2</sub>	419	16 <sup>1</sup> / <sub>2</sub>	419
	C	7	178	7	178	7	178	7	178
	D	4	102	5	127	4	102	5	127
	E	8	203	9	229	8	203	9	229



**Meets or exceeds  
military vibration for  
Truck Transport test**  
MIL-STD-810F  
500,000 mile equivalent

Model with hose & bumper	Shipping Weight	Hose I.D.	Hose O.D.	Hose Length	Max Pressure	NPT(M) Hose Outlet	NPT(F) Reel Inlet	NPT(F) Reel Outlet	Size Index #
	lbs kg	in mm	in mm	ft m	psi bar	in	in	in	
<b>Low Pressure Air/Water Reels</b> Maximum Temperature 150°F (65°C) Max working pressure is at 70°F (20°C)									
DP5450 OLP	37 17	1/4 6	.475 12	50 15	300 21	1/4	1/2	3/8	1
DP5635 OLP	41 19	3/8 10	.600 15	35 11	300 21	1/4	1/2	1/2	1
DP5650 OLP	44 20	3/8 10	.600 15	50 15	300 21	1/4	1/2	1/2	2
DP7650 OLP	50 23	3/8 10	.600 15	50 15	300 21	1/4	1/2	1/2	3
DP5835 OLP	52 24	1/2 13	.750 19	35 11	300 21	3/8	1/2	1/2	2
DP7850 OLP	53 24	1/2 13	.750 19	50 15	300 21	3/8	1/2	1/2	4
<b>Medium Pressure Oil Reels</b> Maximum Temperature 210°F (99°C)									
DP7850 OMP	64 29	1/2 13	.820 21	50 15	3000 207	1/2	1/2	1/2	4
<b>High Pressure Grease Reels</b> Maximum Temperature 210°F (99°C)									
DP7650 OHP	65 29	3/8 10	.730 19	50 15	4800 331	1/4	1/2	3/8	3

Low pressure reels supplied with PVC hose. Medium pressure reels supplied with S.A.E. 100R17 (1/2") one wire braid hose. High pressure reels supplied with S.A.E. 100 R2T two wire braid hose.

Model without hose & bumper	Shipping Weight	Hose Capacity				Max Pressure	NPT(F) Reel Inlet	NPT(F) Reel Outlet	Size Index #
	lbs kg	I.D.	O.D.	Length		psi bar	in	in	
<b>Low Pressure Air/Water Reels</b> Maximum Temperature 210°F (99°C)									
DP7800 OLP	45 20	1/2 13	.750 19	50 15	500 35		1/2	1/2	4
<b>Medium Pressure Oil Reels</b> Maximum Temperature 210°F (99°C)									
DP7600 OMP	45 20	3/8 10	.690 18	50 15	3000 207		1/2	1/2	3
DP7800 OMP	45 20	1/2 13	.820 21	50 15	3000 207		1/2	1/2	4

### Features

- **Superior corrosion-resistance** - A double adhesive gasket seals the spring case.
- **Ease of operation** - The latch pawl is mounted on the guide arm to prevent latch out at full extension.



### Interactive Reel Catalog

Visit [reelcraft.com/catalog](http://reelcraft.com/catalog) for complete product specifications, parts, and accessories.



### Pivot Bases & Swing Brackets

See page 39

## Ultimate Duty Spring Retractable Reels

**Air/Water/Oil** - 3/4", 1", 1 1/2" I.D.



- Ideal for service trucks, permanent service, or plant work areas
- Substantial base frame – full width frame has the greatest amount of mounting area and overall strength of reels within its class
- Latch and ratchet are made of heavy duty cast aluminum to limit the opportunity for premature wear
- Reels are shipped in the bottom wind position with right hand inlet; see Hose Guide Roller Position for other options

**\*Series G9000 reels have an external drive spring and a removable gooseneck.**

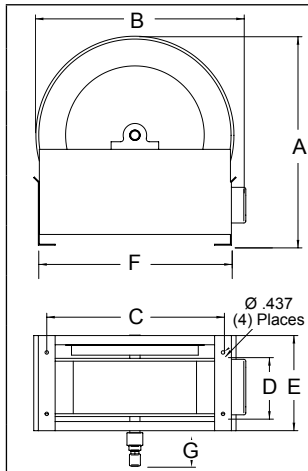

	Size Index									
	1		2		3		4		5	
	in	mm	in	mm	in	mm	in	mm	in	mm
<b>A</b>	26 3/8	670	26 3/8	670	26 1/4	667	26 1/4	667	26 3/8	670
<b>B</b>	26 1/4	667	26 1/4	667	26 1/4	667	26 1/4	667	26 1/4	667
<b>C</b>	22 1/4	565	22 1/4	565	22	559	22	559	22 1/4	565
<b>D</b>	7 3/4	197	7 3/4	197	8	203	9 1/2	241	13 1/2	343
<b>E</b>	12	305	13 3/8	340	14 5/8	371	17 1/4	438	17 3/4	451
<b>F</b>	24 1/8	613	24 1/8	613	24 1/4	616	24 1/4	616	24 1/8	613
<b>G</b>	4 3/4	121	4 1/2	114	4 7/8	124	3 7/8	98	3 7/8	98



E9450 OLPBW

**Meets or exceeds military vibration for Truck Transport test MIL-STD-810F 500,000 mile equivalent**

**Additional Series 9000 Models**  
**Fuel Delivery** - Page 16  
**S.S. Fluid Path** - Page 19

### Hose Guide Roller Position

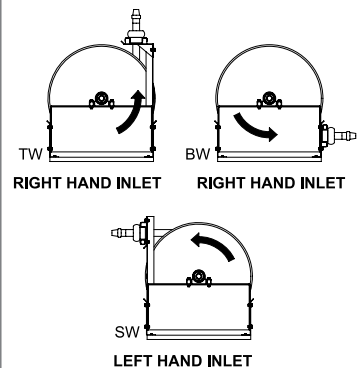

Reels are shipped in the bottom wind (BW) position. Kits are available for top wind (TW) and side wind (SW) position. Contact Reelcraft for more information.

Model with hose & bumper	Shipping Weight		Hose I.D.		Hose O.D.		Hose Length		Max Pressure		NPT(M) Hose Outlet	NPT(F) Reel Inlet	NPT(F) Reel Outlet	Size Index #
	lbs	kg	in	mm	in	mm	ft	m	psi	bar	in	in	in	
<b>Low Pressure Air/Water Reels</b> Maximum Temperature 150°F (65°C) Max working pressure is at 70°F (20°C)														
E9350 OLPBW	140	64	3/4	19	1.075	27	50	15	250	17	3/4	3/4	3/4	1
E9375 OLPBW	152	69	3/4	19	1.075	27	75	23	250	17	3/4	3/4	3/4	1
E9399 OLPBW	143	65	3/4	19	1.075	27	100	30	250	17	3/4	3/4	3/4	2
E9450 OLPBW	157	71	1	25	1.375	35	50	15	250	17	3/4	1	1	1
G9465 OLPBW	157	71	1	25	1.48	38	65	20	250	17	3/4	1	1	3
<b>Medium Pressure Oil Reels</b> Maximum Temperature 210°F (99°C)														
E9350 OMPBW	142	64	3/4	19	1.188	30	50	15	1250	86	3/4	3/4	3/4	1

Low pressure reels supplied with PVC hose. Medium pressure reels supplied with S.A.E. 100R1-AT (3/4") one wire braid hose.

Model without hose & bumper	Shipping Weight		Hose Capacity						Max Pressure		NPT(F) Reel Inlet	NPT(F) Reel Outlet	Size Index #
			I.D.		O.D.		Length						
	lbs	kg	in	mm	in	mm	ft	m	psi	bar	in	in	
Low Pressure Air/Water Reels			Maximum Temperature 210°F (99°C)										
E9305 OLPBW	115	52	3/4	19	1.075	27	100	30	500	35	3/4	3/4	2
E9400 OLPBW	115	52	1	25	1.375	35	50	15	500	35	1	1	1
FF9600 OLPBW	135	61	1½	38	2.000	51	50	15	600	41	1 1/2	1 1/2	5
G9600 OLPBW*	157	71	1½	38	2.000	51	50	15	600	41	1 1/2	1 1/2	4
Medium Pressure Oil Reels			Maximum Temperature 210°F (99°C)										
E9300 OMPBW	117	53	3/4	19	1.188	30	50	15	3000	207	3/4	3/4	1
G9300 OMPBW*	160	73	3/4	19	1.188	30	75	23	3000	207	3/4	1	3
E9400 OMPBW	120	54	1	25	1.480	38	50	15	3000	207	1	1	1
G9400 OMPBW*	159	72	1	25	1.480	38	75	23	3000	207	1	1	3



### Interactive Reel Catalog

Visit [reelcraft.com/catalog](http://reelcraft.com/catalog) for complete product specifications, parts, and accessories.



### Hose Assemblies & Bumper Stops

See pages 36-37



### Roller Guide Kits

See page 38

## Spring Retractable Fuel Hose Reels

3/4", 1", 1 1/2" I.D.

- Ideal for mobile and permanent-mount applications
- Suitable for a wide variety of fuel applications including E85 (not recommended for jet fuel)
- Incorporates metal forms to ensure the greatest possible strength
- Latch and ratchet are made of heavy duty cast aluminum to limit the opportunity for premature wear
- Reels are all supplied with our ball-bearing style swivel



F7925 OLP

Model with hose & bumper	Shipping Weight		Hose I.D.		Hose O.D.		Hose Length		Max Pressure		NPT(M) Hose Outlet	NPT(F) Reel Inlet	NPT(F) Reel Outlet	Size Index Page	Size Index #
	lbs	kg	in	mm	in	mm	ft	m	psi	bar	in	in	in		
<b>Low Pressure Fuel Reels</b> Maximum Temperature 150°F (65°C)															
F7925 OLP	47	21	3/4	19	1.188	30	25	8	*50	3	3/4	3/4	3/4	12	---
FHD79035 OLP	79	36	3/4	19	1.188	30	35	11	*50	3	3/4	3/4	3/4	13	2
F83050 OLP	89	40	3/4	19	1.188	30	50	15	*50	3	3/4	3/4	3/4	14	1
FD83075 OLP	115	52	3/4	19	1.188	30	75	23	*50	3	3/4	3/4	3/4	14	2
FD84035 OLP	94	43	1	25	1.500	38	35	11	*50	3	1	1	1	14	3
FD84050 OLP	115	52	1	25	1.500	38	50	15	*50	3	1	1	1	14	3
FSD14050 OLP	127	58	1	25	1.500	38	50	15	*50	3	1	1	1	refer to reelcraft.com	
FE9450 OLPBW	157	71	1	25	1.500	38	50	15	*50	3	1	1	1	16	1

\*Models supplied with UL330 and cUL Nitrile synthetic rubber (ORS) hose. 250 psi minimum burst (17 Bar). Flow rates of fuel hose are reduced by 30% with addition of internal spring type bend restrictors. For example, flow rate of F7925 OLP with internal bend restrictors is 9.0 GPM at 40 psi; flow without internal bend restrictors is 13.0 GPM at 40 psi.



**Interactive Reel Catalog**

Visit [reelcraft.com/catalog](http://reelcraft.com/catalog) for complete product specifications, parts, and accessories.

Model without hose & bumper	Shipping Weight		Hose Capacity						Max Pressure		NPT(F) Reel Inlet	NPT(F) Reel Outlet	Size Index Page	Size Index #
			I.D.		O.D.		Length							
	lbs	kg	in	mm	in	mm	ft	m	psi	bar	in	in		
Low Pressure Fuel Reels      Maximum Temperature 210°F (99°C)														
F7900 OLP	45	20	3/4	19	1.188	30	25	8	500	35	3/4	3/4	12	---
F83000 OLP	74	34	3/4	19	1.188	30	50	15	500	35	3/4	3/4	14	1
FD83000 OLP	82	37	3/4	19	1.188	30	75	23	500	35	3/4	3/4	14	2
FD84000 OLP	84	38	1	25	1.500	38	50	15	500	35	1	1	14	3
FE9400 OLPBW	115	52	1	25	1.500	38	50	15	500	35	1	1	16	1
FF9600 OLPBW	135	61	1 1/2	38	2.000	51	50	15	600	41	1 1/2	1 1/2	16	5



**Series 9000 Roller Guide Kits**  
See page 38



**Pivot Bases & Swing Brackets**  
See page 39

Hose Assemblies	Hose I.D.		Hose O.D.		Hose Length		Max Pressure		End Fittings	Shipping Weight	
	in	mm	in	mm	ft	m	psi	bar		in - NPT(M)	lbs
Low Pressure Fuel Inlet Hose 4 spiral poly yarn braid											
S600451-2	1	25	1.500	38	2	0.6	50	3	1 x 1	1.7	0.8
Low Pressure Fuel Outlet Hoses 4 spiral poly yarn braid											
S600160-1	3/4	19	1.188	30	25	8	50	3	3/4 x 3/4	17.5	7.9
S600160-4	3/4	19	1.188	30	35	11	50	3	3/4 x 3/4	24.5	11.1
S600160-2	3/4	19	1.188	30	50	15	50	3	3/4 x 3/4	35.0	15.9
S600160-3	3/4	19	1.188	30	75	23	50	3	3/4 x 3/4	52.5	23.8
S600451-35	1	25	1.500	38	35	11	50	3	1 x 1	30.0	13.6
S600451-50	1	25	1.500	38	50	15	50	3	1 x 1	42.0	19.1
Caution: Be sure working pressure required does not exceed above ratings. Misapplication can result in serious operator injury.											



S600451-35



S600160-2



## Spring Retractable DEF Hose Reels



1/2", 3/4" I.D.

- Designed to aid in the dispensing of Diesel Exhaust Fluid (DEF) for late model diesel engines
- These reels are an integral part of emerging DEF service stations in marinas, truck stops, and garages
- Internal fluid path parts are made from 304L grade stainless steel and feature HNBR O-rings
- Steel stampings are engineered with structural forms to give added strength and rigidity
- Models with hose include DEF dispensing hose with stainless steel fittings and NPT threads
- Guide arm adjusts to seven positions



UR7850 OLB

Model with hose & bumper	Shipping Weight		Hose I.D.		Hose O.D.		Hose Length		Max Pressure		NPT(M) Hose Outlet	NPT(F) Reel Inlet	NPT(F) Reel Outlet	Size Index Page	Size Index #
	lbs	kg	in	mm	in	mm	ft	m	psi	bar	in	in	in		
<b>Low Pressure DEF Reels</b> Maximum Temperature 150°F (65°C)															
UR7850 OLB	51	23	1/2	13	.844	22	50	15	300	21	1/2	1/2	1/2	12	---
UR7925 OLB	53	24	3/4	19	1.13	29	25	8	300	21	3/4	3/4	3/4	12	---
UR83050 OLB	93	42	3/4	19	1.13	29	50	15	300	21	3/4	3/4	3/4	14	1

Model without hose & bumper	Shipping Weight		Hose Capacity						Max Pressure		NPT(F) Reel Inlet	NPT(F) Reel Outlet	Size Index Page	Size Index #
			I.D.		O.D.		Length							
	lbs	kg	in	mm	in	mm	ft	m	psi	bar	in	in		
Low Pressure Air/Water Reels      Maximum Temperature 210°F (99°C)														
UR7800 OLB	44	20	1/2	13	.844	22	50	15	500	35	1/2	1/2	12	---
UR7900 OLB	44	20	3/4	19	1.13	29	25	8	500	35	3/4	3/4	12	---
UR83000 OLB	51	23	3/4	19	1.13	29	50	15	300	21	3/4	3/4	14	1



### Interactive Reel Catalog

Visit [reelcraft.com/catalog](http://reelcraft.com/catalog) for complete product specifications, parts, and accessories.



### Pivot Bases & Swing Brackets

See page 39



### Hose Bumper Stops

See page 36

## Static Discharge / Bonding Reels

- Used to bond equipment operating in hazardous atmospheres
- Dissipates static electrical buildup, reducing the chances of sparking and the potential for explosion
- Made from industrial grade carbon steel
- Reels require little mounting space for applications where space is a critical requirement
- Easily adjust spring tension – loosening two screws allows user to add or remove spring tension (except GHC3100 N)



G 3050

Model	Cable Extended		Clamp Rating	Rewind Method	Max Temp		Cable Notes	Shipping Weight	
	ft	m			°F	°C		lbs	kg
G 3050	50	15	100 AMP	Spring	150	66	Single 7 x 7 stranded steel*	12	5
G 3050 Y	50	15	100 AMP	Spring	150	66	35' (9.2m) plus dual 15' (4.6m) for Y* Total extension 50' (15m)	12	5
G 3050 N	50	15	100 AMP	Spring	150	66	Hi-vis orange nylon covered cable**	12	5
GA3100 N	100	30	100 AMP	Spring	125	52	Hi-vis orange nylon covered cable**	16	7
GHC3100 N	100	30	100 AMP	Hand Crank	125	52	Hi-vis orange nylon covered cable**	12	5

\*3/32" OD aircraft cable. DC resistance is approximately one ohm per 50 ft. of cable. \*\*Nylon covered cable (1/8" O.D.). Refer to reelcraft.com for dimensions.



GHC3100 N

## Twin Hose, Spring Retractable Reels Dual Hydraulic - 1/4", 3/8", 1/2" I.D.



- Used for medium pressure, dual hydraulic hose applications
- Ideal for operating hydraulic cylinders, tools, and equipment
- Incorporates contemporary engineering and manufacturing techniques to give a trouble-free performance
- Declutching arbor virtually eliminates the possibility of spring damage due to reverse winding
- Constant tension or pos-i-latch spool mechanism
- Hose specifications - polyester elastomer tube with proprietary polyurethane blend, perforated black cover
- Individually powder coated components offer the maximum protection from premature corrosion
- All-steel construction and compact for applications with critical space requirement

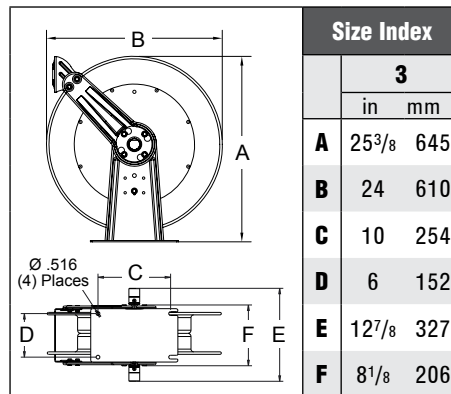
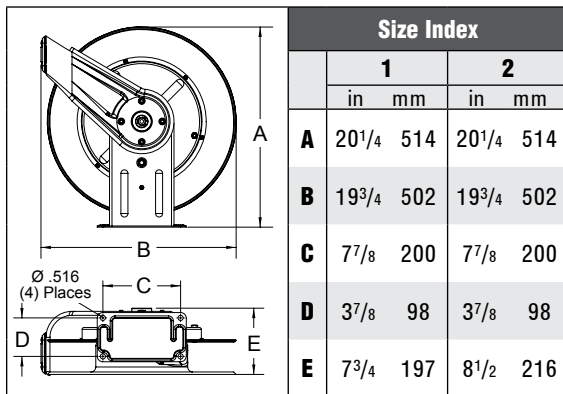

**Meets or exceeds  
military vibration  
for Truck  
Transport test  
MIL-STD-810F  
500,000 mile  
equivalent**

TH5400 OMP not included

Model with hose & bumper	Shipping Weight		Hose I.D.		Hose O.D.		Hose Length		Max Pressure	NPT(M) Hose Outlet	NPT(F) Reel Inlet	Reel Outlet	Size Index #
	lbs	kg	in	mm	in	mm	ft	m	psi	bar	in	in	
<b>Medium Pressure Hydraulic Reels</b> Maximum Temperature 210°F (99°C)													
THA7630 OMP	53	24	3/8	6	.660	17	30	9	2000	138	3/8	3/8	9/16-18 JIC(M)
TH86050 OMP	99	45	3/8	10	.710	18	50	15	2000	138	3/8	3/8	3/8 NPT(F)
THA7825 OMP	57	26	1/2	13	.850	22	25	8	2000	138	3/4 JIC(F)	1/2	3/4 JIC(M)
TH88050 OMP	104	47	1/2	13	.850	22	50	15	2000	138	1/2	1/2	1/2" NPT(F)



**Interactive  
Reel Catalog**

Visit [reelcraft.com/catalog](http://reelcraft.com/catalog)  
for complete product  
specifications, parts, and  
accessories.

Model without hose & bumper	Shipping Weight		Hose Capacity						Max Pressure		NPT(F) Reel Inlet	Reel Outlet	Size Index #
			I.D.		O.D.		Length						
	lbs	kg	in	mm	in	mm	ft	m	psi	bar	in	in	
Medium Pressure Hydraulic Reels      Maximum Temperature 210°F (99°C)													
TH5400 OMP	24	11	1/4	6	.530	13	25	8	3000	207	1/4	1/4 NPT(F)	*
THA7600 OMP	44	20	3/8	10	.660	17	30	9	3000	207	3/8	9/16-18 JIC(M)	1
THA7800 OMP	50	23	1/2	13	.850	22	25	8	3000	207	1/2	3/4 JIC(M)	1
TH88000 OMP	88	40	1/2	13	.850	22	50	15	3000	207	1/2	1/2" NPT(F)	3
*See page 9 size index 1													

\*See page 9 size index 1



**Adjustable  
Bumper Stops**  
See page 36



**Pivot Bases &  
Swing Brackets**  
See page 39

## Spring Retractable Pre-Rinse Reels

Water - 3/8", 1/2" I.D.

### Pre-Rinse

- A lever-operated spray valve is included (S600080)
- Optional 360° rotating swivel (600248) offers 20° of angular motion
- Low-pressure 3/8 in. x 35 ft. rubber hose included; rated for hot water up to 180 °F (82 °C)
- The reliable speed latch allows for positive locking of the spool in two positions per rotation
- Guide arm adjusts to two positions



5635 OLPSW5



**Interactive  
Reel Catalog**

Visit [reelcraft.com/catalog](http://reelcraft.com/catalog) for complete product specifications, parts, and accessories.



**Pre-Rinse Spray Valve**  
S600080



Model with hose & bumper	Shipping Weight		Hose I.D.		Hose O.D.		Hose Length		Max Pressure		NPT(M) Hose Outlet	NPT(F) Reel Inlet	NPT(F) Reel Outlet	Size Index Page	Size Index #
	lbs	kg	in	mm	in	mm	ft	m	psi	bar	in	in	in		
<b>Pre-Rinse Hose Reels</b> Maximum temperature 180°F (82°C)															
<b>5635 OLPSW5</b>	27	12	3/8	10	.660	17	35	11	125	9	3/8	3/8	1/4	10	1



**Pivot Bases & Swing Brackets**  
See page 39

## Stainless Steel Fluid Path Hose Reels

1/2", 3/4", 1" I.D.

- Offers another level of protection in corrosive environments
- Stainless steel swivel and stainless steel main shaft - all components in contact with media
- Cast aluminum ratchet and latch pawl provide reliability and durability
- By design, the ratchet and latch pawl are substantially thicker than competing reels to reduce wear and increase service life
- Steel components are individually powder coated prior to assembly to maximize corrosion resistance



HD79005 OLB



Model without hose & bumper	Shipping Weight		Hose Capacity						Max Pressure		NPT(F) Reel Inlet	NPT(F) Reel Outlet	Size Index Page	Size Index #
			I.D.		O.D.		Length							
	lbs	kg	in	mm	in	mm	ft	m	psi	bar	in	in		
Low Pressure Air/Water Reels      Maximum Temperature 210°F (99°C)														
HD78005 OLB	54	24	1/2	13	.750	19	75	23	500	35	1/2	1/2	13	2
HD79005 OLB	54	24	3/4	19	1.075	27	50	15	500	35	3/4	3/4	13	2
E9305 OLBWW	115	52	3/4	19	1.075	27	100	30	500	35	3/4	3/4	16	2
E9400 OLBWW	115	52	1	25	1.375	35	50	15	500	35	1	1	16	1



**Series 9000  
Roller Guide Kits**  
See page 38



**Pivot Bases & Swing Brackets**  
See page 39

## Spring Retractable, Hand Crank, Motor Driven Hose Reels

**Water** - 1/4", 3/8", 1/2" I.D.

- Compact design and quality steel construction
- The high pressure water swivel is designed to handle a broad range of pressures, temperatures, and chemicals
- Ideal for agricultural, marine, equipment cleaning, and pressure washing applications
- Individually powder coated components offer maximum protection from premature corrosion
- Models without hose are rated up to 5000 PSI
- Full flow swivel combines the highest grade seal design and materials with bearing areas to ensure maximum service life
- Available in hand crank, spring driven, or electric motor driven models



CA38106 M

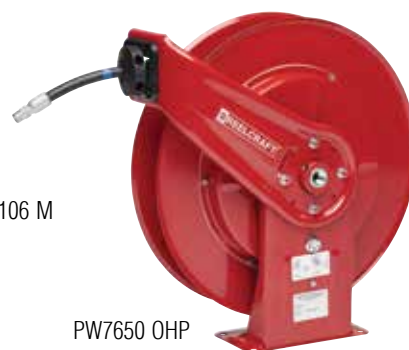

PW7650 OHP



CA6000 H



**Hand crank and motor driven aluminum pressure wash reels**  
See page 23.

	in mm		in mm		in mm		Shipping Weight	Max Pressure	NPT(F) Reel Inlet	NPT(F) Reel Outlet	Size Index Page	Size Index #
Hose I.D.	1/4	6	3/8	10	1/2	13						
Hose O.D.	.530	13	.730	19	.850	22						
Model without hose	Hose Length											
	ft	m	ft	m	ft	m	lbs kg	psi bar	in	in		
Manual Hand Crank Pressure Wash Reels Maximum Temperature 210°F (99°C)												
CA6000 H	100	30	50	15	---	---	18 8	5000 345	3/8	1/4	refer to reelcraft.com	
CT6050HN	---	---	50	15	---	---	13 6	5000 345	1/2	3/8	---	1
CT6100HN	---	---	100	30	---	---	17 8	5000 345	1/2	3/8	---	2
CA38106 M	200	61	140	43	100	30	41 19	5000 345	1/2	1/2	25	---
CA38112 M	425	130	300	91	200	61	46 21	5000 345	1/2	1/2	25	---
Electric Motor Driven Pressure Wash Reels Maximum Temperature 212°F (100°C)												
EA38106 M12D	200	61	140	43	100	30	63 29	5000 345	1/2	1/2	25	---
EA38112 M12D	425	130	300	91	200	61	71 32	5000 345	1/2	1/2	25	---
PSI rating based upon 2.4 to 1 safety factor. Motor control accessories not included.												

PSI rating based upon 2.4 to 1 safety factor. Motor control accessories not included.

Model with hose & bumper	Shipping Weight		Hose I.D.		Hose O.D.		Hose Length		Max Pressure		NPT(M) Hose Outlet	NPT(F) Reel Inlet	NPT(F) Reel Outlet	Size Index Page	Size Index #
	lbs	kg	in	mm	in	mm	ft	m	psi	bar	in	in	in		
<b>Spring Retractable Pressure Wash Reels</b> Maximum Temperature 210°F (99°C)															
PW7650 OHP	60	27	3/8	10	.730	19	50	15	4800	331	1/4	1/2	3/8	12	---
PWD76075 OHP	90	41	3/8	10	.730	19	75	23	4800	331	1/4	1/2	3/8	13	2
PW81100 OHP	119	54	3/8	10	.730	19	100	30	4800	331	3/8	1/2	3/8	14	1

PSI rating based upon 2.4 to 1 safety factor.

Model without hose & bumper	Shipping Weight		Hose Capacity						Max Pressure		NPT(F) Reel Inlet	NPT(F) Reel Outlet	Size Index Page	Size Index #
			I.D.		O.D.		Length							
	lbs	kg	in	mm	in	mm	ft	m	psi	bar	in	in		
Spring Retractable Pressure Wash Reels    Maximum Temperature 210°F (99°C)														
PW7600 OHP	43	20	3/8	10	.730	19	50	15	5000	345	1/2	3/8	12	---
PW81000 OHP	86	39	3/8	10	.730	19	100	30	5000	345	1/2	3/8	14	1
PSI rating based upon 2.4 to 1 safety factor.														

PSI rating based upon 2.4 to 1 safety factor.

Dimensions				
	1		2	
	in	mm	in	mm
A	15 <sup>5</sup> / <sub>8</sub>	397	15 <sup>5</sup> / <sub>8</sub>	397
B	13 <sup>1</sup> / <sub>4</sub>	337	13 <sup>1</sup> / <sub>4</sub>	337
C	3 <sup>1</sup> / <sub>2</sub>	89	3 <sup>1</sup> / <sub>2</sub>	89
D	4 <sup>1</sup> / <sub>4</sub>	108	4 <sup>1</sup> / <sub>4</sub>	108
E	15 <sup>1</sup> / <sub>2</sub>	394	19 <sup>1</sup> / <sub>2</sub>	495
F	6	152	6	152

The image contains technical drawings of two speaker models, labeled 1 and 2. Model 1 is shown in a side view with dimensions E (total height), F (height of the central driver area), and D (height of the mounting bracket). Model 2 is shown in a front view with dimensions B (width), A (height), and Ø .413 (diameter of the mounting holes). Both models are shown with a mounting bracket and a cable.

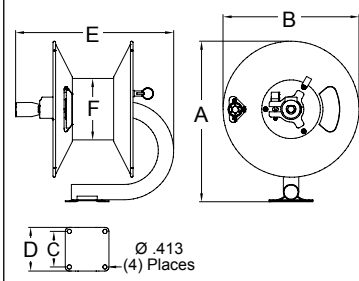

### Interactive Reel Catalog

Visit [reelcraft.com/catalog](http://reelcraft.com/catalog) for complete product specifications, parts, and accessories.



### High Pressure Hose Assemblies & Bumper Stops

See pages 36-37



## Spring Retractable Hose Reels



**Water** - 1/2", 5/8", 3/4" I.D.

- Most models include outlet hose with brass on/off ball valve, bumper, and inlet hose providing a reel solution out of the box
- Comes equipped with garden hose end fittings
- Guide arm is easily adjustable to numerous positions
- All steel parts are individually powder-coated for maximum corrosion resistance
- Designed to be mounted centrally and used for watering and washdown
- Reel components are made from industrial-grade steel



GCD83075 OLP



**Interactive Reel Catalog**

Visit [reelcraft.com/catalog](http://reelcraft.com/catalog) for complete product specifications, parts, and accessories.



**Pivot Bases & Swing Brackets**  
See page 39



**Hose Assemblies & Bumper Stops**  
See pages 36-37

Model with hose & bumper	Shipping Weight		Hose I.D.		Hose O.D.		Hose Length		Pressure		GH(M) Hose Outlet	GH(F) Reel Inlet	Inlet Hose (included)	Size Index Page	Size Index #
	lbs	kg	in	mm	in	mm	ft	m	psi	bar	in	in			
<b>Low Pressure Air/Water Reels</b> Maximum temperature 150°F (65°C)															
7850 OLPSW57	51	24	1/2	13	.810	21	50*	15	150	21	3/4	1/2 NPT	-----	12	----
GC82075 OLP	88	40	1/2	75	.750	19	75	23	150	18	3/4	3/4	S601025-8	14	1
GC7535 OLP	53	24	5/8	16	1.00	26	35	11	150	18	3/4	3/4	S600830-10	12	----
GCD85100 OLP	101	46	5/8	16	1.00	26	100	31	150	18	3/4	3/4	S600830-10	14	2
GC83050 OLP	89	41	3/4	19	1.075	27	50	15	150	18	3/4	3/4	S600830-10	14	1
GCD83075 OLP	102	46	3/4	19	1.075	27	75	23	150	18	3/4	3/4	S600830-10	14	2

\*50 ft. hose assembly is yellow; does not include ball valve or inlet hose.

## Portable Hose Reel and Cart



**Water** - 1/2", 1" I.D.

- Series 30000 reels mounted on a portable cart are designed for rugged, heavy-duty applications requiring long lengths of hose and large storage capacity



600965

### Additional Hoses

1" ID x 100', 1" NPT x 1" NPSH: **S600982-100**

3/4" ID x 150', 3/4" NPT x 1" NPSH: **S601044-150**

1" ID x 10', 1" NPT x 1" NPSH: **S600982-10**

### Garden Fitting Conversion Kits

1/2" NPTM x 3/4" GH: **S260729**

3/4" NPTM x 3/4" GH: **S261702**

Hose Reel and Cart Packages	
Package	Items Included
<b>600966</b>	1/2" x 200' hand crank hose reel (CA32112 L); 12" hand cart with semi-pneumatic tires (600741-2); 5/8" x 10' PVC inlet hose (600962)
<b>600968</b>	1" x 100' hand crank hose reel (CH37118 L); 18" hand cart with semi-pneumatic tires (600885-2); 1" x 10' PVC inlet hose (S600982-10)

Refer to page 25 for Series 30000 hose reel dimensions and specifications.

	600741-2		600885-2	
	Reel Size		Reel Size	
	12"	18"	12"	18"
	in	mm	in	mm
<b>A</b>	Adjustable*			
<b>B</b>	23 3/4	603	28 3/4	730
<b>C</b>	18 1/4	464	18 1/4	464

\*Handle height of cart is adjustable to 35 5/8", 38 5/8", 41 1/2" or 44 1/2". Eight 5/16" (8mm) diameter mounting holes.

## Stainless Steel Hose Reels

**Air/Water/Oil** - 3/8", 1/2", 3/4", 1" I.D.

- Constructed from electropolished 304L stainless steel
- Ideal for food processing, pre-rinse, wash down, chemical transfer, marine applications, and industrial-solvent handling
- Stainless steel components offer the maximum protection from premature corrosion

7800 OLS



83000 OLS



Model without hose & bumper	Shipping Weight		Hose Capacity						Max Pressure		NPT(F) Reel Inlet	NPT(F) Reel Outlet	Size Index Page	Size Index #		
			I.D.		O.D.		Length									
	lbs	kg	in	mm	in	mm	ft	m	psi	bar	in	in				
Spring Retractable Low Pressure Air/Water Reels															Maximum Temperature 210°F (99°C)	
81000 OLS-S	77	35	3/8	10	.600	15	100	30	500	35	1/2	1/2	14	1		
7800 OLS	41	19	1/2	13	.750	19	50	15	500	35	1/2	1/2	12	---		
7800 OLS-S	41	19	1/2	13	.750	19	50	15	500	35	1/2	1/2	12	---		
82000 OLS	81	37	1/2	13	.750	19	100	30	500	35	1/2	1/2	14	1		
82000 OLS-S	81	37	1/2	13	.750	19	100	30	500	35	1/2	1/2	14	1		
83000 OLS	81	37	3/4	19	1.188	30	50	15	500	35	3/4	3/4	14	1		
83000 OLS-S	81	37	3/4	19	1.188	30	50	15	500	35	3/4	3/4	14	1		
D83000 OLS	84	38	3/4	19	1.188	30	75	23	500	35	3/4	3/4	14	2		
D83000 OLS-S	84	38	3/4	19	1.188	30	75	23	500	35	3/4	3/4	14	2		
D84000 OLS	92	42	1	25	1.375	35	50	15	500	35	1	1	14	3		
D84000 OLS-S	92	42	1	25	1.375	35	50	15	500	35	1	1	14	3		
Spring Retractable Medium Pressure Oil Reels															Maximum Temperature 210°F (99°C)	
7600 OMS55	42	19	3/8	10	.710	18	66	20	3000	207	3/8	3/8	12	---		
81000 OMS-S	83	38	3/8	10	.710	18	100	30	1500	103	1/2	1/2	14	1		
7800 OMS	43	20	1/2	13	.850	22	50	15	3000	207	1/2	1/2	12	---		

**Spring Retractable Reels Note:** Standard latch parts are made from aluminum. Series 80000 and D80000 stainless reels have an aluminum fluid path. The -S models include stainless latch parts and fluid path (OLS-S).

**Manual Crank Reels Note:** The Series HS models include aluminum hubs and bronze bushings.



**Hose Assemblies & Bumper Stops**  
See pages 36-37

Model without hose & bumper	Shipping Weight		Pressure		NPT(F) Outlet	NPT(F) Inlet	I.D.	1/4		3/8		1/2		3/4		---	
								6	10	13	18	22	22	30	35	---	---
	lbs	kg	psi	bar	in	in	O.D.	.530	.710	.850	1.188	1.375	1.375	1.375	1.375	---	---
<b>Hand Crank Medium Pressure Reels</b> Maximum temperature 210°F (99°C)																	
HS18000 M	36	16	3000	207	1/2	1/2	Hose Capacity	425	130	300	91	200	61	---	---	---	---
HS19000 M	38	17	3000	207	3/4	3/4		425	130	300	91	200	61	75	23	---	---

Refer to reelcraft.com for dimensions.

## Heavy Duty Aluminum Hand Crank, Motor Driven Hose Reels



**NEW!**

**Water/Oil/Chemical** - 3/8", 1/2", 5/8", 3/4" I.D.

- Aluminum construction is 50% lighter in weight than carbon steel
- Hardware includes a two-coat plating process that resists salt spray and acids
- 3/4" fluid path constructed of 316 stainless steel is designed to handle harsh chemicals; this model includes a stainless steel swivel rated to 3000 PSI
- Includes spring loaded latching mechanism and drag brake to control over spooling
- Innovative design allows for the handle or swivel to be easily swapped from one side to the other
- Hose not included
- Available in hand crank or electric motor driven models



**Motor Driven**  
E23018



**Hand Crank**  
C23018

Model without Hose & Bumper	Finish	Spool Width	Shipping Weight		Max Pressure	
			lbs	kg	psi	bar
Hand Crank Medium Pressure Reels			Maximum Temperature 150°F (65°C) Maximum Working Pressure is at 70°F (20°C)			
C23012	Powder Coated	12"	21.5	10	3000	207
C23018	Powder Coated	18"	23.5	10	3000	207
C23022	Powder Coated	22"	25	11	3000	207
C23012 310	Tumbled Natural	12"	21.5	10	3000	207
C23018 310	Tumbled Natural	18"	23.5	10	3000	207
C23022 310	Tumbled Natural	22"	25	11	3000	207
12 V DC Motor Driven Medium Pressure Reels			Maximum Temperature 150°F (65°C) Maximum Working Pressure is at 70°F (20°C)			
E23012	Powder Coated	12"	24.5	11	3000	207
E23018	Powder Coated	18"	26.5	12	3000	207
E23022	Powder Coated	22"	28	13	3000	207
E23012 310	Tumbled Natural	12"	24.5	11	3000	207
E23018 310	Tumbled Natural	18"	26.5	12	3000	207
E23022 310	Tumbled Natural	22"	28	13	3000	207
Hand Crank High Pressure Reels			Maximum Temperature 210°F (99°C) Maximum Working Pressure is at 70°F (20°C)			
C23012 H	Powder Coated	12"	21.5	10	4500	310
C23018 H	Powder Coated	18"	23.5	10	4500	310
C23022 H	Powder Coated	22"	25	11	4500	310
C23012 H 310	Tumbled Natural	12"	21.5	10	4500	310
C23018 H 310	Tumbled Natural	18"	23.5	10	4500	310
C23022 H 310	Tumbled Natural	22"	25	11	4500	310
12 V DC Motor Driven High Pressure Reels			Maximum Temperature 210°F (99°C) Maximum Working Pressure is at 70°F (20°C)			
E23012 H	Powder Coated	12"	24.5	11	4500	310
E23018 H	Powder Coated	18"	26.5	12	4500	310
E23022 H	Powder Coated	22"	28	13	4500	310
E23012 H 310	Tumbled Natural	12"	24.5	11	4500	310
E23018 H 310	Tumbled Natural	18"	26.5	12	4500	310
E23022 H 310	Tumbled Natural	22"	28	13	4500	310
Medium pressure reels supplied with Stainless Steel 3000 psi swivel. High pressure reels supplied with Carbon Steel 4500 psi swivel.						

Medium pressure reels supplied with Stainless Steel 3000 psi swivel. High pressure reels supplied with Carbon Steel 4500 psi swivel.

Hose Diameter				
ID	3/8"	1/2"	5/8"	3/4"
OD	0.71"	0.85"	0.94"	1.08"
Spool Width	Hose Capacity			
12"	300'	200'	150'	125'
18"	500'	300'	250'	200'
22"	600'	350'	300'	250'
Dimensions - Width				
	Spool	12"	18"	22"
<b>A</b>	Motor Driven	28"	34"	38"
<b>A</b>	Hand Crank	25"	31"	35"
<b>B</b>	Mounting Pattern	16.88"	22.88"	26.88"
<b>C</b>	Mounting Pattern	11"	17"	21"
<b>D</b>	Mounting Pattern	18"	24"	28"

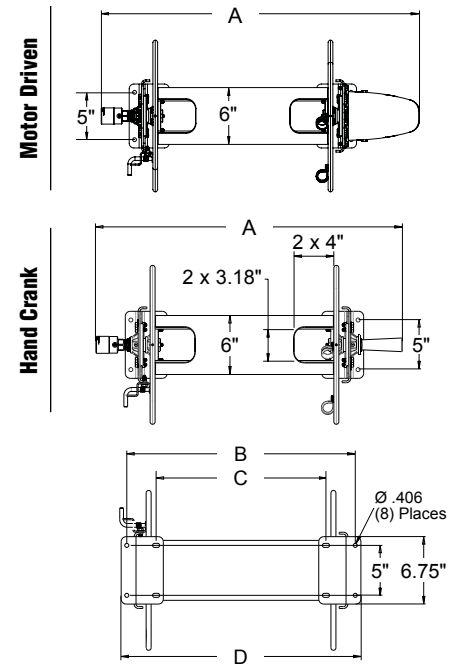

## Optional Spray Reel Accessories See pages 38-39.



### Side Wind Roller Guide Kit

Our SW Roller Guide Kit makes it easier to pull the hose at higher elevations.

### Bottom Wind Roller Guide Kit

Our BW Roller Guide Kit makes it easier to pull the hose at lower elevations.

### Stacking Brackets Kit

Stacking brackets are easy to install, allowing you to customize your setup to suit your needs.

### Whip Hose—Chemical S602975

- 3/4" ID, Stainless Steel Ends  
- 200 PSI

### Whip Hose—Power Wash S602976

- 1/2" ID  
- Plated Carbon Steel Ends  
- 4300 PSI

## Light Duty Hand Crank Hose Reels

**Air/Water** - 3/8", 1/2" I.D.

- Designed for lighter-duty applications that require longer lengths of low pressure hose
- Incorporates a balanced brass swivel, brass inlet, lighter weight components, and forward-thinking design
- All reels feature a drag break to prevent de-spooling when reel is not in use



CU6050LN

### Additional Series C Models

Pressure Wash Reels - Page 20

Dimensions								
	1		2		3		4	
	in	mm	in	mm	in	mm	in	mm
<b>A</b>	11 <sup>1</sup> / <sub>2</sub>	292	11 <sup>1</sup> / <sub>2</sub>	292	14 <sup>3</sup> / <sub>8</sub>	365	14 <sup>3</sup> / <sub>8</sub>	365
<b>B</b>	10 <sup>1</sup> / <sub>2</sub>	267	10 <sup>1</sup> / <sub>2</sub>	267	13 <sup>1</sup> / <sub>4</sub>	337	13 <sup>1</sup> / <sub>4</sub>	337
<b>C</b>	2	51	2	51	2 <sup>3</sup> / <sub>8</sub>	60	2 <sup>3</sup> / <sub>8</sub>	60
<b>D</b>	6 <sup>5</sup> / <sub>8</sub>	168	11 <sup>1</sup> / <sub>8</sub>	283	6 <sup>1</sup> / <sub>4</sub>	159	10 <sup>1</sup> / <sub>4</sub>	260
<b>E</b>	16 <sup>3</sup> / <sub>4</sub>	425	21 <sup>1</sup> / <sub>8</sub>	537	16 <sup>3</sup> / <sub>4</sub>	425	20 <sup>7</sup> / <sub>8</sub>	530
<b>F</b>	4	102	4	102	6	152	6	152
<b>G</b>	9 <sup>3</sup> / <sub>8</sub>	238	13 <sup>7</sup> / <sub>8</sub>	352	9 <sup>1</sup> / <sub>4</sub>	235	13 <sup>1</sup> / <sub>4</sub>	337
<b>H</b>	3 <sup>3</sup> / <sub>8</sub>	86	3 <sup>3</sup> / <sub>8</sub>	86	4	102	4	102

Model without hose	Shipping Weight		Hose Capacity						Max Pressure		NPT(F) Reel Inlet	NPT(F) Reel Outlet	Size Index Page	Size Index #
			I.D.		O.D.		Length							
	lbs	kg	in	mm	in	mm	ft	m	psi	bar	in	in		
Low Pressure Air/Water Reels      Maximum Temperature 150°F (65°C)														
CU6050LN	12	5	3/8	10	.600	15	50	15	300	21	3/8	3/8	----	1
CT6050LN	13	6	3/8	10	.600	15	50	15	300	21	3/8	3/8	22	1
CU6100LN	16	7	3/8	10	.600	15	100	30	300	21	1/2	1/2	----	2
CU8050LN	13	6	1/2	13	.750	19	50	15	300	21	1/2	1/2	----	3
CU8100LN	20	9	1/2	13	.750	19	100	30	300	21	1/2	1/2	----	4

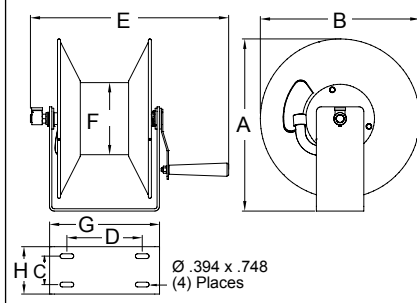

## Hand Crank and Motor Driven Reels

**Series 30000 - Air/Water/Oil** - 1/2", 3/4", 1" I.D.

- Designed for rugged applications requiring long lengths of hose and large storage capacity
- All-bolted unitized construction with no welds to fatigue, full flow swivel, heavy duty gauge steel frame and spool, and aluminum drum ensure the longest service life
- The T-handle tensioning device allows proper tension to be applied to the spool to eliminate the free spooling of the reel
- Vibration-proof, self-locking fasteners are ideal for industrial use or field use such as turf care or pest control
- Optional spring driven lock pin to prevent spool rotation when the reel is not in use, S600874 (not shown)



Removable gooseneck makes hose installation easy.



Change the tension on your reel using the T-handle.



**Hand Crank**  
CA32112 L



**Motor Driven**  
EA32112 L12D



**Rewind Motors & Operating Switches**  
See page 38



**Roller Guide Assemblies**  
See page 39

### Interactive Reel Catalog



Visit [reelcraft.com/catalog](http://reelcraft.com/catalog) for complete product specifications, parts, and accessories.



**E**   **A**   **3**   **3**   **1**   **06**   **L**   **12D**

**Drive Type**

A - Air motor  
B - Bevel crank  
C - Hand crank  
E - Electric motor

**Swivel Size**

2 - 1/2" (13 mm) I.D.  
3 - 3/4" (19 mm) I.D.  
6 - 1/4" (6 mm) Dual  
7 - 1" (25 mm) I.D.  
8 - 1/2" (13 mm) I.D. pressure wash

**Width of Spool**

See "F" Dimension  
06 - 6" (152 mm)  
12 - 12" (305 mm)  
18 - 18" (457 mm)  
22 - 22" (559 mm)  
28 - 27" (711 mm)

**Motor Voltage/H.P.**

Blank - No Motor  
12D - 12 V DC  
4A - 1 1/2 HP air motor

**Fluid Path Type**

A - Gooseneck  
H - Heavy duty gooseneck (1" only)

**Pressure**

L - 1000 PSI (69 bar)  
M - 3000 PSI (207 bar)

**NOTE:** Chart is for reference only. Not all options available in every combination. Reels cannot be ordered by selecting from this chart.

Hose I.D.	1/4"	3/8"	1/2"	3/4"	1"
	6 mm	10 mm	13 mm	19 mm	25 mm
Hose O.D.	.530"	.710"	.850"	1.188"	1.375"
	13 mm	18 mm	22 mm	30 mm	35 mm
"F" Width	Hose Capacity				
6"	200'	140'	100'	50'	N/A
152 mm	61 m	43 m	30 m	15 m	
12"	425'	300'	200'	100'	50'
305 mm	130 m	91 m	61 m	30 m	15 m
18"	625'	450'	325'	175'	100'
457 mm	191 m	137 m	99 m	54 m	31 m
22"	780'	550'	400'	225'	125'
559 mm	238 m	168 m	122 m	69 m	38 m
27"	1000'	700'	500'	275'	150'
686 mm	305 m	213 m	152 m	84 m	46 m

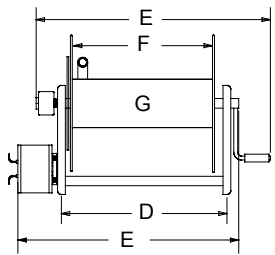
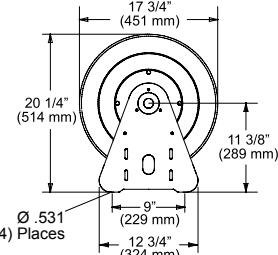
## Additional Series 30000 Models

**Pressure Wash -**  
Page 20

**Hose Reel Cart -**  
Page 21

**Gas/Cable Welding -**  
Pages 32-34

Model without hose & bumper	Shipping Weight		Hose Capacity						Max Pressure		NPT(F) Reel Inlet	NPT(F) Reel Outlet	D		E		F		G	
			I.D.		O.D.		Length													
	lbs	kg	in	mm	in	mm	ft	m	psi	bar	in	in	in	mm	in	mm	in	mm	in	mm
Manual Hand Crank Hose Reels      Maximum Temperature 210°F (99°C)																				
CA32106 L	40	18	1/2	13	.750	19	100	30	100	69	1/2	1/2	9 <sup>3</sup> / <sub>4</sub>	248	19 <sup>3</sup> / <sub>4</sub>	502	6	152	6 <sup>3</sup> / <sub>8</sub>	162
CA32112 L	46	21	1/2	13	.750	19	200	61	1000	69	1/2	1/2	15 <sup>3</sup> / <sub>4</sub>	400	25 <sup>3</sup> / <sub>4</sub>	654	12	305	6 <sup>3</sup> / <sub>8</sub>	162
CA32118 L	51	23	1/2	13	.750	19	325	99	1000	69	1/2	1/2	21 <sup>3</sup> / <sub>4</sub>	552	31 <sup>3</sup> / <sub>4</sub>	806	18	457	6 <sup>3</sup> / <sub>8</sub>	162
CA32106 M	42	19	1/2	13	.850	22	100	30	3000	207	1/2	1/2	9 <sup>3</sup> / <sub>4</sub>	248	19 <sup>3</sup> / <sub>4</sub>	502	6	152	6 <sup>3</sup> / <sub>8</sub>	162
CA32112 M	46	21	1/2	13	.850	22	200	61	3000	207	1/2	1/2	15 <sup>3</sup> / <sub>4</sub>	400	25 <sup>3</sup> / <sub>4</sub>	654	12	305	6 <sup>3</sup> / <sub>8</sub>	162
CA32118 M	52	24	1/2	13	.850	22	325	99	3000	207	1/2	1/2	21 <sup>3</sup> / <sub>4</sub>	552	31 <sup>3</sup> / <sub>4</sub>	806	18	457	6 <sup>3</sup> / <sub>8</sub>	162
CA33106 L	41	19	3/4	19	1.075	27	50	15	1000	69	3/4	3/4	9 <sup>3</sup> / <sub>4</sub>	248	19 <sup>3</sup> / <sub>4</sub>	502	6	152	6 <sup>3</sup> / <sub>8</sub>	162
CA33112 L	46	21	3/4	19	1.075	27	100	30	1000	69	3/4	3/4	15 <sup>3</sup> / <sub>4</sub>	400	25 <sup>3</sup> / <sub>4</sub>	654	12	305	6 <sup>3</sup> / <sub>8</sub>	162
CA33118 L	51	23	3/4	19	1.075	27	175	53	1000	69	3/4	3/4	21 <sup>3</sup> / <sub>4</sub>	552	31 <sup>3</sup> / <sub>4</sub>	806	18	457	6 <sup>3</sup> / <sub>8</sub>	162
CA33112 M	47	21	3/4	19	1.188	30	100	30	3000	207	3/4	3/4	15 <sup>3</sup> / <sub>4</sub>	400	25 <sup>3</sup> / <sub>4</sub>	654	12	305	6 <sup>3</sup> / <sub>8</sub>	162
CA33118 M	51	23	3/4	19	1.188	30	175	53	3000	207	3/4	3/4	21 <sup>3</sup> / <sub>4</sub>	552	31 <sup>3</sup> / <sub>4</sub>	806	18	457	6 <sup>3</sup> / <sub>8</sub>	162
CH37112 L*	60	27	1	25	1.375	35	50	15	1000	69	1	1	15 <sup>3</sup> / <sub>4</sub>	400	25 <sup>3</sup> / <sub>4</sub>	654	12	305	8	203
CH37118 L*	64	29	1	25	1.375	35	100	30	1000	69	1	1	21 <sup>3</sup> / <sub>4</sub>	552	31 <sup>3</sup> / <sub>4</sub>	806	18	457	8	203
Electric Motor Driven Hose Reels      Maximum Temperature 210°F (99°C). Motor control accessories not included.																				
EA32106 L12D	60	27	1/2	13	.750	19	100	30	1000	69	1/2	1/2	9 <sup>3</sup> / <sub>4</sub>	248	19 <sup>5</sup> / <sub>8</sub>	498	6	152	6 <sup>3</sup> / <sub>8</sub>	162
EA32112 L12D	64	29	1/2	13	.750	19	200	61	1000	69	1/2	1/2	15 <sup>3</sup> / <sub>4</sub>	400	23 <sup>7</sup> / <sub>8</sub>	606	12	305	6 <sup>3</sup> / <sub>8</sub>	162
EA32118 L12D	68	31	1/2	13	.750	19	325	99	1000	69	1/2	1/2	21 <sup>3</sup> / <sub>4</sub>	552	29 <sup>5</sup> / <sub>8</sub>	752	18	457	6 <sup>3</sup> / <sub>8</sub>	162
EA33106 L12D	63	29	3/4	19	1.075	27	50	15	1000	69	3/4	3/4	9 <sup>3</sup> / <sub>4</sub>	248	19 <sup>5</sup> / <sub>8</sub>	498	6	152	6 <sup>3</sup> / <sub>8</sub>	162
EA33112 L12D	68	31	3/4	19	1.075	27	100	30	1000	69	3/4	3/4	15 <sup>3</sup> / <sub>4</sub>	400	23 <sup>7</sup> / <sub>8</sub>	606	12	305	6 <sup>3</sup> / <sub>8</sub>	162
EA33118 L12D	68	31	3/4	19	1.075	27	175	53	1000	69	3/4	3/4	21 <sup>3</sup> / <sub>4</sub>	552	29 <sup>5</sup> / <sub>8</sub>	752	18	457	6 <sup>3</sup> / <sub>8</sub>	162
EH37118 L12D*	82	37	1	25	1.375	35	100	30	1000	69	1	1	21 <sup>3</sup> / <sub>4</sub>	552	31	787	18	457	8	203
Air Motor Driven Hose Reels      Filter, regulator, lubricator required. Maximum Temperature 210°F (99°C). Motor control accessories not included.																				
AA32106 L4A	54	24	1/2	13	.750	19	100	30	1000	69	1/2	1/2	9 <sup>3</sup> / <sub>4</sub>	248	17 <sup>1</sup> / <sub>4</sub>	438	6	152	6 <sup>3</sup> / <sub>8</sub>	162
CAUTION: To prevent drum damage fully extend and pressurize hose and rewind on the reel. *All 1 in. reel models have an 8 in. (203 mm) diameter carbon steel drum.																				

**CAUTION:** To prevent drum damage fully extend and pressurize hose and rewind on the reel. \*All 1 in. reel models have an 8 in. (203 mm) diameter carbon steel drum.

Many more reel models available in addition to chart. Refer to [reelcraft.com](http://reelcraft.com) for details.

# Reelcraft: Safer by Design

## Adjustable Bumper Stop

Allows any desired length of cord to be maintained outside the reel.

## Corrosion-Resistant

Steel components are individually powder coated to virtually eliminate corrosion.

## Reelcraft offers many styles of outlets and lamps

- Single receptacle
- Twist lock
- Duplex outlet box
- Triple tap
- Quad outlet box
- Reverse plug
- Flying lead
- LED
- GFCI

## Easy to Mount

Attaches to most structurally sound surfaces. Edges are curved for safety.

**Note:** Swing brackets should be used if cords are pulled at more than 45°, see page 39.



600993

## Adjustable Cord Bumpers

Model	Outside Diameter of Cord	Cord Specifications		
	in (mm)	AWG	mm <sup>2</sup>	# Cond.
<b>S600193</b>	.320(8) - .530(14)	16	1.33	3
<b>S1-HR1004-A</b>	.438(11) - .625(16)	12	3.32	3
<b>S1-HR1004</b>	.625(16) - .749(19)	12	3.32	3
<b>S3-HR1004-3</b>	1.06(27) - 1.38(35)	6	8.00	3

## Adjustable Guide Arm

Multiple guide arm positions for versatile uses and easier field adjustment.

## Enclosed Drive Spring

Drive mechanism is enclosed for protection against the environment.

## Long Life Drive Spring

Declutching arbor virtually eliminates possibility of spring damage due to reverse winding of reel spool.

## Structural Strength

Robotically welded heavy gauge steel frame.

Shown: L 4545 123 3

## Model Number Significance

This chart is for reference purposes only. Reels cannot be ordered by selecting from this chart. Please refer to selection charts on pages 27-30 or consult Reelcraft for any questions about option combinations.

**L 4050163 \***

### REEL SERIES

40 = SERIES 4000  
45 = SERIES 4500  
55 = SERIES 5500  
57 = SERIES 5700  
70 = SERIES 7000  
or SERIES 70000

### WIRE SIZE

10 = 10 GAUGE  
12 = 12 GAUGE  
16 = 16 GAUGE

### LENGTH OF CORD

00 = W/O CORD  
25 = 25 FEET  
30 = 30 FEET  
35 = 35 FEET  
45 = 45 FEET  
50 = 50 FEET  
75 = 75 FEET  
100 = 100 FEET

### STYLE NUMBERS

REFERENCE  
PAGES 27-30  
FOR CORD END  
OPTIONS.

### NO. OF CONDUCTORS

2 = TWO CONDUCTOR  
3 = THREE CONDUCTOR  
4 = FOUR CONDUCTOR

## Third Party Listings



### UL 355 - UL Standard for Safety Cord Reels

**UL Listing** means that **UL** has tested representative samples of a product and determined that the product meets specific, defined requirements. These requirements are often based on **UL's** published and nationally recognized Standards for Safety.

- UL tests the product and the manufacturing facility to certify that the product is safe if used as intended
- Recognized as the standard worldwide
- Mitigates insurance liability



### CSA - C22.2 NO. 21-95 - Cord Sets & Power Supply Cords

**CSA** International certification marks indicate that a product, process or service has been tested to a Canadian or U.S. standard and it meets the requirements of an applicable **CSA** standard or another recognized document used as a basis for certification.

- Similar to UL, but preferred in some instances



L 4545 123 7

## Triple Tap Power Cord Reels



- A heavy duty collector ring assures highest conductivity
- The reliable speed latch allows for positive locking of the spool in two positions per rotation
- Individually powder-coated steel components provide maximum protection from premature corrosion
- Robotically welded steel base offers maximum strength and consistent quality



L 4545 123 9G

Model w/ cord & bumper	Cord Ending	Cord Specifications					Volts	Amps	Shipping Weight		Size Index #	
		AWG	mm <sup>2</sup>	# Cond	ft	m			Type**	lbs		kg
L 4050 163 9	Triple tap outlet NEMA 5-15R, Inlet straight blade plug NEMA 5-15P	16	1.33	3	50	15	SJE00W	125	13	26	12	1
L 4545 123 9		12	3.32	3	45	14	SJE00W	125	15	28	13	1
L 70075 123 9		12	3.32	3	75	23	SE00W	125	15	71	32	5
L 70100 123 9		12	3.32	3	100	30	SE00W	125	15	75	34	5
L 4545 123 9G	Triple tap outlet w/ GFCI* NEMA 5-15R, Inlet straight blade plug NEMA 5-15P	12	3.32	3	45	14	SJE00W	125	15	29	13	1
L 70100 123 9G		12	3.32	3	100	30	SE00W	125	15	76	34	5
L 4545 123 9GC	Triple tap outlet w/ GFCI* NEMA 5-15R Inlet twist lock plug NEMA L5-15P	12	3.32	3	45	14	SJE00W	125	15	29	13	1

**For indoor non-weathertight applications only.** All models UL listed at 125 Volt 60 HZ single phase. Swing brackets or pivot bases should be used if cords are pulled at more than 45°, see page 39. \*The GFCI Receptacle is designed to protect from line-to-ground shock hazards. It does not protect against short circuits or overloads; this is the function of the fuse or circuit breaker. \*\*Cord type designation shows all combinations of cord types that may be used, only UL approved cord types will be used.

### Cord End Specifications

		<b>#9/9G/9GC - Triple Tap</b> 15 Amp molded triple tap. GFCI protection on #9G and #9GC only. NEMA 5-15R

Refer to page 30 for dimensional drawings.

### Interactive Reel Catalog



Visit [reelcraft.com/catalog](http://reelcraft.com/catalog) for complete product specifications, parts, and accessories.

## Single Receptacle Power Cord Reels



Model with cord & bumper	Cord Ending	Cord Specifications					Volts	Amps	Shipping Weight		Size Index #	
		AWG	mm <sup>2</sup>	# Cond	ft	m			Type*	lbs		kg
L 4050 163 3	Single receptacle NEMA 5-15R, Inlet straight blade plug NEMA 5-15P	16	1.33	3	50	15	SJTOW	125	13	26	12	1
L 4545 123 3		12	3.32	3	45	14	SJE0OW	125	15	27	12	1
L 5550 123 3		12	3.32	3	50	15	SJE0OW	125	15	44	20	3
L 70075 123 3		12	3.32	3	75	23	SE0OW	125	15	70	32	5
L 70100 123 3		12	3.32	3	100	30	SE0OW	125	15	74	34	5
L 4525 123 3A	Single receptacle NEMA 5-20R, Inlet straight blade plug NEMA 5-20P	12	3.32	3	25	8	SJE0OW	125	20	25	11	1
L 4545 123 3A		12	3.32	3	45	14	SJE0OW	125	20	28	13	1
L 5550 123 3A		12	3.32	3	50	15	SJE0OW	125	20	44	20	3
L 70075 123 3A		12	3.32	3	75	23	SE0OW	125	20	70	32	5
L 70100 123 3A		12	3.32	3	100	30	SE0OW	125	20	81	37	5
L 4545 123 3AC	Single receptacle NEMA 5-20R, Inlet twist lock plug NEMA L5-20P	12	3.32	3	45	14	SJE0OW	125	20	28	13	1
L 70075 123 3AC		12	3.32	3	75	23	SE0OW	125	20	70	32	5
L 4545 123 3B	Twist lock single receptacle NEMA L5-20R, Inlet straight blade plug NEMA 5-20P	12	3.32	3	45	14	SJE0OW	125	20	28	13	1
L 5550 123 3B		12	3.32	3	50	15	SJE0OW	125	20	44	20	3
L 70100 123 3B		12	3.32	3	100	30	SE0OW	125	20	74	34	5
For indoor non-weathertight applications only. All models UL listed at 125 Volt 60 HZ single phase. Swing brackets or pivot bases should be used if cords are pulled at more than 45°, see page 39. *Cord type designation shows all combinations of cord types that may be used, only UL approved cord types will be used.												



L 5550 123 3A



### Cord End Specifications

		<b>#3 - Single Receptacle</b> Single 15 AMP with clamp type strain relief for 16 and 12 AWG cord. NEMA 5-15R
		<b>#3A/3AC - Single Receptacle</b> Single 20 AMP. NEMA 5-20R
		<b>#3B - Twist Lock Receptacle</b> Single 20 AMP with twist lock connector. NEMA L5-20R

Many more cord reel models available in addition to the charts on pages 27-30.

Contact Reelcraft for more information. \*Minimum order quantities may apply

Refer to page 30 for dimensional drawings for all cord reels.

## Flying Lead and Bare Power Cord Reels



Model	Cord Ending	Cord Specifications					Volts/ Amps	Volts/ Amps	Shipping Weight*		Size Index #	
		AWG	mm <sup>2</sup>	# Cond	ft	m			Type**	lbs		kg
L 4050 163 X	Flying lead	16	1.33	3	50	15	SJE0OW	125 / 13	220 / 6.5	26	12	1
L 4545 123 X		12	3.32	3	45	14	SJE0OW	125 / 20	220 / 10	25	11	1
L 5550 123 X		12	3.32	3	50	15	SJE0OW	125 / 20	220 / 10	35	16	3
L 70100 123 X		12	3.32	3	100	30	SE0OW	125 / 20	220 / 10	73	33	6
L 5550 124 X		12	3.32	4	50	15	SE0OW	-----	600 / 16	43	20	3
L 70100 124 X		12	3.32	4	100	30	SE0OW	-----	600 / 16	75	34	6
L 5750 103 X		10	5.27	3	50	15	SE0OW	125 / 30	220 / 15	55	25	4
L 7050 104 X		10	5.27	4	50	15	SE0OW	-----	600 / 20	65	29	7
L 4500	Bare reel	12	3.32	3	45	14	SJE0OW	125 / 20	220 / 10	21	10	1
L 70100		12	3.32	3	100	30	SE0OW	125 / 20	220 / 10	58	26	6
L 70100 124		12	3.32	4	100	30	SE0OW	-----	600 / 16	75	34	6
L 5000		10	5.27	3	35	11	SO	125 / 30	220 / 15	29	13	2
L 5700		10	5.27	3	50	15	SE0OW	125 / 30	220 / 15	37	17	4
L 7000		6	13.3	4	35	11	SOOW	-----	220 / 45	41	19	7
For indoor non-weathertight applications only. All models UL listed at 125/220 Volt 60 HZ single phase. Swing brackets or pivot bases should be used if cords are pulled at more than 45°, see page 39. Flying lead models include cord and bumper. **Equivelant cord type may be used.												



L 70100 123 X



### Cord End Specifications

		<b>X - Flying Lead</b> Flying leads on inlet and outlet and conduit box.
--	--	---



## Duplex and Quad Box Power Cord Reels



Model with cord & bumper	Cord Ending	Cord Specifications					Volts	Amps	Shipping Weight		Size Index	
		AWG	mm <sup>2</sup>	# Cond	ft	m			Type**	lbs		kg
L 4545 123 7	Duplex box outlet with GFCI* NEMA 5-15R, Inlet straight blade plug NEMA 5-15P	12	3.32	3	45	14	SJE00W	125	15	29	13	1
L 5550 123 7		12	3.32	3	50	15	SE00W	125	15	45	20	3
L 4525 123 7A	Duplex box outlet with GFCI* NEMA 5-20R, Inlet straight blade plug NEMA 5-20P	12	3.32	3	25	8	SJE00W	125	20	27	12	1
L 4545 123 7A		12	3.32	3	45	14	SJE00W	125	20	29	13	1
L 5550 123 7A		12	3.32	3	50	15	SE00W	125	20	45	20	3
L 70100 123 7A		12	3.32	3	100	30	SE00W	125	20	76	34	5
L 4545 123 7AC	Duplex box outlet with GFCI NEMA 5-20R, Inlet twist lock plug NEMA L5-20P	12	3.32	3	45	14	SJE00W	125	20	29	13	1
L 4545 123 7B	Duplex box outlet NEMA 5-20R, Inlet straight blade plug NEMA 5-20P	12	3.32	3	45	14	SJE00W	125	20	29	13	1
L 4525 123 7BC	Duplex box outlet NEMA 5-20R, Inlet twist lock plug NEMA L5-20P	12	3.32	3	25	8	SJE00W	125	20	27	12	1
L 4525 123 7Q	Quad box outlet NEMA 5-20R, Inlet straight blade plug NEMA 5-20P	12	3.32	3	25	8	SJE00W	125	20	27	12	1
L 4545 123 7Q		12	3.32	3	45	14	SJE00W	125	20	29	13	1
L 5550 123 7Q		12	3.32	3	50	15	SJE00W	125	20	45	20	3
L 4525 123 7QC	Quad box outlet NEMA 5-20R, Inlet twist lock plug NEMA L5-20P	12	3.32	3	25	8	SJE00W	125	20	27	12	1
L 4545 123 7QC		12	3.32	3	45	14	SJE00W	125	20	29	13	1
L 70100 123 7QC		12	3.32	3	100	30	SE00W	125	20	76	34	5

**For indoor non-weathertight applications only.** All models UL listed at 125 Volt 60 HZ single phase. Swing brackets or pivot bases should be used if cords are pulled at more than 45°, see page 39. \*The GFCI Receptacle is designed to protect from line-to-ground shock hazards. It does not protect against short circuits or overloads; this is the function of the fuse or circuit breaker. \*\*Equivalent cord type may be used.

Refer to page 30 for dimensional drawings for all cord reels.

## Reverse Plug Power Cord Reels

- Ideal for mounting on mobile equipment
- Reversed plug ends allow the male end to be reeled out the desired length
- Female end is stationary for plugging in mobile equipment



Model with cord & bumper	Cord Ending	Cord Specifications					Volts	Amps	Shipping Weight		Size Index #	
		AWG	mm²	# Cond	ft	m			Type*	lbs		kg
L 4035 163 3-RP	Outlet straight blade plug NEMA 5-15P, Inlet single receptacle NEMA 5-15R	16	1.33	3	35	11	SJE00W	125	13	26	12	1
L 4050 163 3-RP		16	1.33	3	50	15	SJE00W	125	13	29	13	1
L 4545 123 3-RP		12	3.32	3	45	14	SJE00W	125	15	28	13	1
L 4545 123 3A-RP	Outlet straight blade plug NEMA 5-20P, Inlet single receptacle NEMA 5-20R	12	3.32	3	45	14	SJE00W	125	20	28	13	1

**For indoor non-weathertight applications only.** All models UL listed at 125 Volt 60 HZ single phase. Pivot base should be used if cords are pulled at more than 45°, see page 39. \*Equivalent cord type may be used.



L 4545 123 7



### Cord End Specifications

	<b>#7 - Duplex Outlet Box</b> 15 AMP duplex outlet box with GFCI protection. Includes flip cover. NEMA 5-15R
	<b>#7A/7AC/7B/7BC - Duplex Outlet Box</b> 20 AMP duplex outlet box. GFCI protection on #7A/7AC. Includes flip cover. NEMA 5-20R
	<b>#7Q/7QC - Quad Box</b> 20 AMP quad outlet box. Four receptacles. Does not include flip cover. NEMA 5-20R



L 4050 163 3-RP

### Reverse Plug

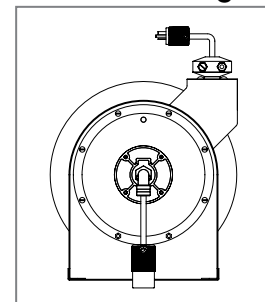

## Light Cord Reels

Model with cord & bumper	Cord Ending	Cord Specifications					Volts	Amps	Shipping Weight		Size Index #
		AWG	mm <sup>2</sup>	# Cond	ft	m			lbs	kg	
<b>L 4035 163 10</b>	LED lamp w/ outlet, Inlet straight blade plug NEMA 5-15P	16	1.33	3	35	11	125	12	26	12	1
<b>L 4050 163 10</b>		16	1.33	3	50	15	125	12	28	13	1

**For indoor non-weathertight applications only.** All models UL listed at 125 Volt 60 HZ single phase. Swing brackets or pivot bases should be used if cords are pulled at more than 45°, see page 39. \*Equivalent cord type may be used.



L 4050 163 10



**#10 - LED Light** (930 lumens)  
Two ultra-high intensity 4-watt LEDs; Single 3-watt end spot light; Polycarbonate shatter-resistant light tube; In-line tool tap, NEMA 5-15R configuration maximum 12 amp draw

**Pivot Bases & Swing Brackets**  
See page 39

- All Series L 4000, L 5000, and L 70000 reel models supplied with cord are complete with a 4-5 foot pigtail and three-prong plug or receptacle (except flying lead reels)
- Compact design
- Durable abrasion and corrosion resistant baked-on powder coat finish

	Dimensions - Size Index							
	1		2		3		4	
	in	mm	in	mm	in	mm	in	mm
<b>A</b>	12 <sup>7</sup> / <sub>8</sub>	327	14 <sup>3</sup> / <sub>8</sub>	365	17 <sup>5</sup> / <sub>8</sub>	448	17 <sup>5</sup> / <sub>8</sub>	448
<b>B</b>	12 <sup>5</sup> / <sub>8</sub>	321	14 <sup>1</sup> / <sub>4</sub>	362	16 <sup>3</sup> / <sub>4</sub>	425	16 <sup>3</sup> / <sub>4</sub>	425
<b>C</b>	8	203	9 <sup>3</sup> / <sub>4</sub>	248	9 <sup>3</sup> / <sub>4</sub>	248	9 <sup>3</sup> / <sub>4</sub>	248
<b>D</b>	2 <sup>1</sup> / <sub>2</sub>	64	2 <sup>1</sup> / <sub>2</sub>	64	2 <sup>1</sup> / <sub>2</sub>	64	2 <sup>1</sup> / <sub>2</sub>	64
<b>E</b>	9 <sup>3</sup> / <sub>8</sub>	239	10 <sup>1</sup> / <sub>2</sub>	267	10 <sup>1</sup> / <sub>2</sub>	267	12 <sup>1</sup> / <sub>2</sub>	318
<b>F</b>	1 <sup>3</sup> / <sub>4</sub>	44	2 <sup>1</sup> / <sub>8</sub>	54	2 <sup>1</sup> / <sub>8</sub>	54	2 <sup>1</sup> / <sub>8</sub>	54

	Dimensions - Size Index					
	5		6		7	
	in	mm	in	mm	in	mm
<b>A</b>	20 <sup>1</sup> / <sub>4</sub>	514	20 <sup>1</sup> / <sub>4</sub>	514	20 <sup>1</sup> / <sub>4</sub>	514
<b>B</b>	19 <sup>3</sup> / <sub>4</sub>	502	19 <sup>3</sup> / <sub>4</sub>	502	19 <sup>3</sup> / <sub>4</sub>	502
<b>C</b>	7 <sup>13</sup> / <sub>16</sub>	198	7 <sup>13</sup> / <sub>16</sub>	198	7 <sup>13</sup> / <sub>16</sub>	198
<b>D</b>	3 <sup>7</sup> / <sub>8</sub>	98	3 <sup>7</sup> / <sub>8</sub>	98	3 <sup>7</sup> / <sub>8</sub>	98
<b>E</b>	11 <sup>3</sup> / <sub>4</sub>	298	12 <sup>1</sup> / <sub>2</sub>	318	14 <sup>5</sup> / <sub>8</sub>	371

## NEMA 4 Power Cord Reels

- NEMA 4 rating provides protection against water or dust, indoor and out
- Cast aluminum construction with yellow powder coat finish
- Large, easy to access junction box
- One inch (NPT) pipe thread opening provided for conduit inlet
- Guide arm is adjustable every 5° over a 270° arc
- Containerized drive spring allows for safer, easier maintenance



L NM445 144 X



**Interactive Reel Catalog**

Visit [reelcraft.com/catalog](http://reelcraft.com/catalog) for complete product specifications, parts, and accessories.



Dimensions						
	A	B	C	D	E	F
in	14 <sup>1</sup> / <sub>2</sub>	13 <sup>1</sup> / <sub>2</sub>	47 <sup>1</sup> / <sub>16</sub>	3 <sup>1</sup> / <sub>16</sub>	9 <sup>5</sup> / <sub>8</sub>	7 <sup>1</sup> / <sub>4</sub>
mm	368	343	113	78	244	184

Model with cord & bumper	Cord Ending	Cord Specifications					Volts	Amps	Shipping Weight	
		AWG	mm <sup>2</sup>	# Cond.	ft	m			lbs	kg
<b>L NM450 163 X</b>	Flying Lead	16	1.31	3	50	15	SOW	600	9	43 20
<b>L NM445 144 X</b>		14	2.08	4	45	14	SOW	600	11	50 23
<b>L NM450 123 X</b>		12	3.31	3	50	15	SOW	600	18	50 23

All models UL listed at 125 Volt 60 HZ single phase. One inch (NPT) pipe thread opening provided for conduit inlet.

## Single Line Welding Inlet Hose Assemblies

Part Number	Hose I.D.		Length		End Fittings	Pressure		Weight	
	in	mm	ft	m	in	psi	bar	lbs	kg
<b>T-Grade Hoses</b>									
S601162-2	1/4	6	2	0.61	9/16-18 LH(F)	200	14	0.4	0.18
S601162-4	1/4	6	4	1.22	9/16-18 LH(F)	200	14	0.8	0.36
S601162-6	1/4	6	6	1.83	9/16-18 LH(F)	200	14	1.2	0.54
S601163-2	3/8	10	2	0.61	9/16-18 LH(F)	200	14	0.4	0.18
S601163-4	3/8	10	4	1.22	9/16-18 LH(F)	200	14	0.8	0.36
S601163-6	3/8	10	6	1.83	9/16-18 LH(F)	200	14	1.2	0.54

NOTE: All single line welding inlet hose assemblies listed include all the required adapters to connect to the reel. No additional purchase necessary.



S601163-4

## Single Line Welding Outlet Hose Assemblies

Part Number	Hose I.D.		Length		End Fittings	Pressure		Weight	
	in	mm	ft	m	in	psi	bar	lbs	kg
<b>T-Grade Hoses</b>									
S601162-25	1/4	6	25	8	9/16-18 LH(F)	200	14	3	1.4
S601162-50	1/4	6	50	15	9/16-18 LH(F)	200	14	5	2.3
S601163-50	3/8	10	50	15	9/16-18 LH(F)	200	14	6	2.7
S601163-100	3/8	10	100	30	9/16-18 LH(F)	200	14	12	5.4



S601162-50

## Twin Line Welding Inlet Hose Assemblies

Part Number	Hose I.D.		Length		End Fittings	Pressure		Weight	
	in	mm	ft	m	in	psi	bar	lbs	kg
<b>T-Grade Hoses</b>									
S601031-2	1/4	6	2	0.61	9/16-18 LH/RH(F)	200	14	0.70	0.32
S601031-4	1/4	6	4	1.22	9/16-18 LH/RH(F)	200	14	1.12	0.51
S601031-6	1/4	6	6	1.83	9/16-18 LH/RH(F)	200	14	1.90	0.86
601040-6	3/8	10	6	1.83	9/16-18 LH/RH(F)	200	14	2	0.91

NOTE: Inlet connection fittings required to connect to the reel. See Twin Hose Inlet Connection Fittings table below.



S601031-4

## Twin Line Welding Outlet Hose Assemblies

Part Number	Hose I.D.		Length		End Fittings	Pressure		Weight	
	in	mm	ft	m	in	psi	bar	lbs	kg
<b>T-Grade Hoses</b>									
601031-25	1/4	6	25	8	9/16-18 LH/RH(F)	200	14	6.5	3.0
601031-50	1/4	6	50	15	9/16-18 LH/RH(F)	200	14	12.1	5.5
601031-60	1/4	6	60	18	9/16-18 LH/RH(F)	200	14	14.4	6.5
601031-100	1/4	6	100	30	9/16-18 LH/RH(F)	200	14	24.2	11
601040-50	3/8	10	50	15	9/16-18 LH/RH(F)	200	14	15.5	7
601040-75	3/8	10	75	23	9/16-18 LH/RH(F)	200	14	18	8.2
601040-100	3/8	10	100	30	9/16-18 LH/RH(F)	200	14	23.3	10.6



601040-75

## Twin Hose Inlet Connection Fittings

Part Number	Inlet Connection Fittings
S300090	Acetylene - B size 9/16 - 18 LH (M) x 1/4" NPT (M) 90°
S300091	Oxygen - B size 9/16-18 RH (M) x 1/4" NPT (M) 90°
261371	Oxygen - B size 9/16 - 18 RH (M) x 3/8" NPT (M)
261372	Acetylene - B size 9/16 - 18 LH (M) x 3/8" NPT (M)

Advise product to be handled, maximum temperature, and pressure fitting size when ordering. **Caution:** Be sure working pressure required does not exceed above ratings.

## Spring Retractable Single Line Fuel Gas Welding Hose Reels



**Series SW** - 1/4", 3/8" I.D.

### Reel

- Hard coated, wear-resistant aluminum double-sealed full flow swivel
- Corrosion resistant baked-on powder coat

### Hose

- Ideal for welding service – meets ARPM IP-7 and CGA E-1 standards for T-grade
- Non-conductive
- **Tube:** Synthetic rubber compound compatible with all common welding fuel gases
- **Reinforcement:** Spiral synthetic yarn
- **Cover:** Red synthetic rubber with ribbed surface



SW5450 OLPT

SWHD76100 OLPT



**NOTE:** All Series SW reels are listed to UL 1351 (reel only)



**Pivot Bases & Swing Brackets**  
See page 39



**Inlet & Outlet Hoses**  
See page 31

### Features

- Designed to improve safety in the work area with an increase in productivity and efficiency
- Full flow shaft swivels
- Double-sealed, O-rings prevent leakage
- Durable abrasion and corrosion resistant baked-on red powder-coated finish
- Reel frame, spool, and drum are fabricated of heavy gauge steel



**Interactive Reel Catalog**

Visit [reelcraft.com/catalog](http://reelcraft.com/catalog) for complete product specifications, parts, and accessories.

Fuel gases commonly used in the welding, pre-heating, soldering, brazing, laboratory, heat gun, and cutting industries including, but not limited to, Acetylene, Hydrogen, Methane, Natural Gas, LP Gas, Mapp, and Propane

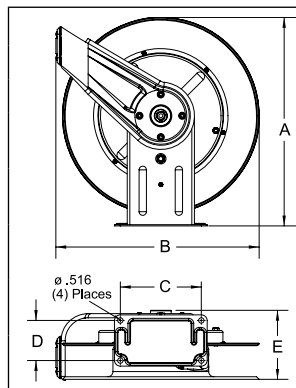

	Size Index					
	1		2		3	
	in	mm	in	mm	in	mm
<b>A</b>	14 <sup>3</sup> / <sub>8</sub>	365	20 <sup>1</sup> / <sub>4</sub>	514	20 <sup>1</sup> / <sub>4</sub>	514
<b>B</b>	13 <sup>3</sup> / <sub>4</sub>	349	19 <sup>3</sup> / <sub>4</sub>	502	19 <sup>3</sup> / <sub>4</sub>	502
<b>C</b>	9 <sup>3</sup> / <sub>4</sub>	248	7 <sup>7</sup> / <sub>8</sub>	200	7 <sup>7</sup> / <sub>8</sub>	200
<b>D</b>	2 <sup>1</sup> / <sub>2</sub>	64	3 <sup>7</sup> / <sub>8</sub>	98	3 <sup>7</sup> / <sub>8</sub>	98
<b>E</b>	6	156	7	178	8 <sup>1</sup> / <sub>4</sub>	210

Model with hose & bumper	Shipping Weight		Hose I.D.		Hose O.D.		Hose Length		Max Pressure		Hose Outlet B Size LH Thread	NPT(F) Reel Inlet	Reel Outlet	Size Index #
	lbs	kg	in	mm	in	mm	ft	m	psi	bar	in	in	in	
Single Line Fuel Gas Welding Reels Maximum Temperature 150°F (65°C)														
SW5450 OLPT	28	13	1/4	6	.530	13	50	15	200	14	9/16 - 18(F)	1/4	9/16-18(M)	1
SW7650 OLPT	43	20	3/8	10	.660	17	50	15	200	14	9/16 - 18(F)	1/2	9/16-18(M)	2
SWHD76100 OLPT	75	34	3/8	10	.660	17	100	30	200	14	9/16 - 18(F)	1/2	9/16-18(M)	3



## Bevel Crank / Spring Retractable Twin Line Gas Welding Hose Reels

### Series BA / TW - 1/4", 3/8" I.D.



- Designed to handle various lengths of oxygen/acetylene or T-grade twin line hose
- Double sealed, special molded o-rings prevent leakage
- Swivel inlets are both permanently identified with machined grooves on the gas side to assure proper installation



TW84100 OLPT



**NOTE:** TW7400 OLPT, TW84000 OLPT, and TW86000 OLPT are listed to UL 1351

	Size Index					
	1		2		3	
	in	mm	in	mm	in	mm
<b>A</b>	20 1/4	514	20 1/4	514	25 3/8	645
<b>B</b>	19 3/4	502	19 3/4	502	24	610
<b>C</b>	7 7/8	200	7 7/8	200	10	254
<b>D</b>	3 7/8	98	3 7/8	98	6	152
<b>E</b>	7 3/8	187	8 1/2	216	12 1/4	311

Series TW5000 reels have four 5/16" (8 mm) diameter mounting holes.

	Size Index			
	4		5	
	in	mm	in	mm
<b>A</b>	15 5/8	397	21 5/8	550
<b>B</b>	6	152	12	305
<b>C</b>	9 3/4	248	15 3/4	400
<b>D</b>	11	280	17	432

Length with crank handle removed is 17 3/4" (451 mm).

### Dual swivel is an exclusive Reelcraft design

The aluminum dual swivel body is hard coated for wear resistance. This assures positive separation of gases due to its unique design. Available with Series TW5000, TW7000, and TWH70000 reels.

Model with hose & bumper	Shipping Weight		Hose I.D.		Hose O.D.		Hose Length		Max Pressure		Hose Outlet (F)	Reel Inlet	Reel Outlet (M)	Size Index #
	lbs	kg	in	mm	in	mm	ft	m	psi	bar	in	in	in	
Twin Line Welding Gas - Oxygen / Acetylene, Mapp, Propane, Natural, and Fuel Gas (T-Grade) Hose Reels														
TW5425 OLPT	26	12	1/4	6	.530	13	25	8	200	14	9/16-18	1/4 NPT(F)	9/16-18	*
TW7450 OLPT	50	23	1/4	6	.530	13	50	15	200	14	9/16-18	1/4 NPT(F)	9/16-18	1
TW7460 OLPT	55	25	1/4	6	.530	13	60	18	200	14	9/16-18	1/4 NPT(F)	9/16-18	1
TWHD74085 OLPT	74	34	1/4	6	.530	13	85	26	200	14	9/16-18	1/4 NPT(F)	9/16-18	2
TW84100 OLPT	101	46	1/4	6	.530	13	100	30	200	14	9/16-18	9/16-18(M)	9/16-18	3
TW86050 OLPT	90	41	3/8	10	.625	16	50	15	200	14	9/16-18	9/16-18(M)	9/16-18	3
TW86075 OLPT	99	45	3/8	10	.625	16	75	23	200	14	9/16-18	9/16-18(M)	9/16-18	3
Acetylene and fuel gas (red) inlet 1/4" FPT / oxygen (green) inlet 1/4" FPT. 9/16-18 models above are B size. Acetylene/fuel gas side has a LH thread and the oxygen side has a RH thread. Maximum temperature 150°F (65°C). *See page 9 size index 1.														

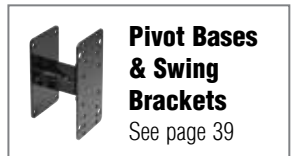

Model without hose & bumper	Shipping Weight		Hose Capacity						Max Pressure		Reel Inlet	Reel Outlet (M)	Size Index #
			I.D.		O.D.		Length						
	lbs	kg	in	mm	in	mm	ft	m	psi	bar	in	in	
Twin Line Welding Gas - Oxygen / Acetylene, Mapp, Propane, Natural, and Fuel Gas (T-Grade) Hose Reels													
TW7400 OLPT	43	20	1/4	6	.530	13	60	18	200	14	1/4 NPT(F)	9/16-18	1
BA36106 LT*	50	23	1/4	6	.530	13	125	38	200	14	1/4 NPT(F)	9/16-18	4
BA36112 LT*	57	26	1/4	6	.530	13	250	76	200	14	1/4 NPT(F)	9/16-18	5
TW84000 OLPT	81	37	1/4	6	.530	13	100	30	200	14	9/16 - 18(M)	9/16-18	3
TW86000 OLPT	86	39	3/8	10	.625	16	75	23	200	14	9/16 - 18(M)	9/16-18	3
Maximum temperature 150°F (65°C). *Bevel crank model.													



## Hand Crank / Spring Retractable Welding Cable Reels Series CEA / WC

- Designed to improve safety in the work area with an increase in efficiency and productivity
- Cable reels have a current path through a continuous 400 or 700 AMP, 90 V DC (maximum) rated enclosed slip ring
- Keeps work area and vehicles better organized, resulting in better space utilization
- Stores cable when not in use, eliminating tangled, kinked welding cables
- Welding cable reels store work lead or electrode lead, up to 4/0, safely and effectively when not in use. Each lead requires a separate reel. When welding also refer to ANSI/Asc Z 49.1
- Maintains proper bend radius of cables, providing longer cable life



**Pivot Bases & Swing Brackets**  
See page 39

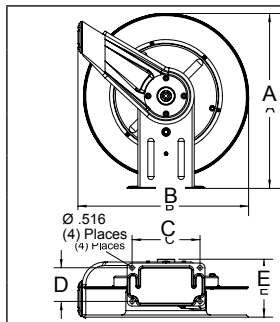

	Size Index					
	1		2		3	
	in	mm	in	mm	in	mm
<b>A</b>	20 <sup>1</sup> / <sub>4</sub>	514	20 <sup>1</sup> / <sub>4</sub>	514	25 <sup>3</sup> / <sub>8</sub>	645
<b>B</b>	19 <sup>3</sup> / <sub>4</sub>	502	19 <sup>3</sup> / <sub>4</sub>	502	24	610
<b>C</b>	7 <sup>7</sup> / <sub>8</sub>	200	7 <sup>7</sup> / <sub>8</sub>	200	10	254
<b>D</b>	3 <sup>7</sup> / <sub>8</sub>	98	3 <sup>7</sup> / <sub>8</sub>	98	6	152
<b>E</b>	13 <sup>1</sup> / <sub>4</sub>	337	14	356	15 <sup>5</sup> / <sub>8</sub>	397

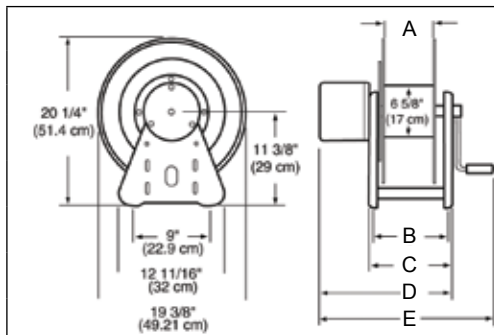

	Size Index			
	4		5	
	in	mm	in	mm
<b>A</b>	6	152	12	305
<b>B</b>	9 <sup>3</sup> / <sub>4</sub>	248	15 <sup>3</sup> / <sub>4</sub>	400
<b>C</b>	11	279	17	432
<b>D</b>	15	381	21	533
<b>E</b>	21	533	27	686

Four 1/2" (12.7 mm) diameter mounting holes.

Model without cable & bumper	Cable Size										Amps	Shipping Weight		Size Index #		
	#2 (34mm²)		#1 (42mm²)		1/0 (54mm²)		2/0 (67mm²)		3/0 (85mm²)						4/0 (107mm²)	
	ft	m	ft	m	ft	m	ft	m	ft	m		ft	m		lbs	kg
CEA30006**	300	91	250	76	200	61	150	46	-----	-----	400	46	21	4		
CEA30012**	500*	152	500*	152	400	122	300	91	-----	-----	400	54	24	5		
WC7000	-----		50	15	50	15	50	15	-----	-----	400	58	26	1		
WCH7000	-----		-----		-----		-----		50	15	50	15	700	58	26	2
WC80001	-----		75	23	75	23	75	23	-----	-----	400	102	46	3		
WC80002	-----		100	30	-----		-----		-----	-----	400	104	47	3		
WCH80001	-----		-----		-----		-----		75	23	75	23	700	102	46	3

\*May exceed maximum cable length allowable for most welding applications.  
**NOTE:** Each cable requires separate reel. \*\*Hand crank reel



WC7000



WC80001



CEA30006



### Interactive Reel Catalog

Visit [reelcraft.com/catalog](http://reelcraft.com/catalog) for complete product specifications, parts, and accessories.

**Caution:** If cable reels are to be used for extended periods of time, unwind all cable from reel to prevent heat build-up. **For indoor non-weathertight applications only.**

Cable Size	Bumper
#2, #1	<b>1-HR1004-A</b>
1/0, 2/0, 3/0	<b>1-HR1004</b>
4/0	<b>2-HR1004-3</b>

## Hand Crank Welding Cable Reels



Up to 175' of 2/0 cable

- Designed for manual winding of welding cable
- Ideal for applications where space, weight, and flexibility are key
- Offer trouble-free management of large capacities of cable
- Glass-filled nylon spools are very strong and durable while ensuring that no conductivity occurs
- A substantial welded aluminum base is used to support the weight of the spool
- Oversized bearings – heavy duty shaft with tapered roller bearings offer high rigidity and spool support

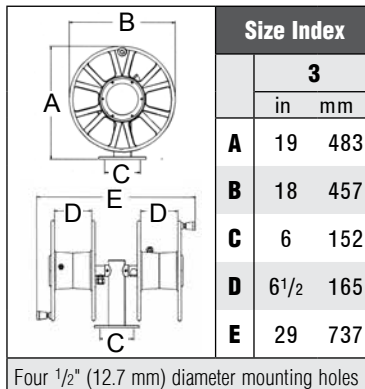
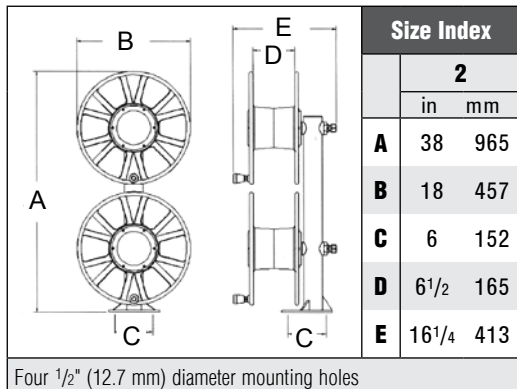
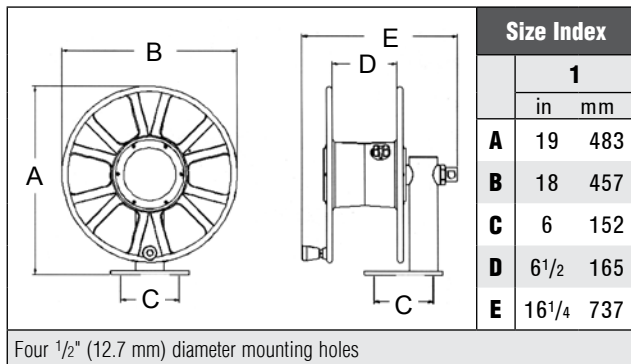

Model without cable	Cable Size						Volts	Amps	Shipping Weight		Size Index #
	#1 (42 mm <sup>2</sup> )		1/0 (54 mm <sup>2</sup> )		2/0 (67 mm <sup>2</sup> )				lbs	kg	
	ft	m	ft	m	ft	m					
Single Welding Cable											
T-1460-0	250	76	200	61	175	53	600	300	32	15	1
Dual Side-by-Side Welding Cable (2)											
T-2462-0	250	76	200	61	175	53	600	250	51	23	3
Dual Stacked Welding Cable (2)											
T-2464-0	250	76	200	61	175	53	600	250	62	28	2
For indoor non-weathertight applications only. Capacity is per spool for dual reels.											



**Side-by-side combinations**  
T-2462-0



**Stacked combinations**  
T-2464-0



**Single welding**  
T-1460-0



**Interactive Reel Catalog**

Visit [reelcraft.com/catalog](http://reelcraft.com/catalog) for complete product specifications, parts, and accessories.

## Spring Retractable Tool Balancers Series TB / TBL

- Balances the weight of assembly tools, making them nearly weightless
- Increases productivity by keeping tools positioned for immediate use with minimal operator motion
- Reduces tool damage by preventing tools from being accidentally dropped
- Reduces operator fatigue and improves safety and ergonomic



TB 05



TBL 10

Model	Min - Max Load		Cable Length*		Shipping Weight		Ratchet Lock
	lbs	kg	ft	m	lbs	kg	
TB 01	0.0 - 1.5	0.0 - 0.7	6	1.8	1.0	0.5	NO
TB 03	1.5 - 3.0	0.7 - 1.4	6	1.8	1.0	0.5	NO
TB 05	3.0 - 5.0	1.4 - 2.3	6	1.8	1.5	1	NO
TBL 10	5.0 - 10	2.3 - 4.5	8	2.4	9	4	YES
TBL 15	10 - 15	4.5 - 6.8	8	2.4	10	4.5	YES
TBL 23	16 - 23	7.2 - 10.4	8	2.4	10	4.5	YES

\*Cable lengths listed are "active" or "working" cable. Maximum temperature 150°F (65°C).

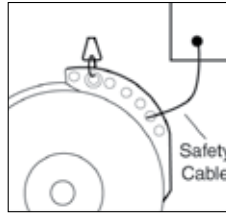

**Bumper - S602413**  
Included with each model.

Strongly recommended, secondary steel cable or steel link chain. Prevents balancer from accidental fall. Balancers have extra holes for cable or chain.

Safety Cable/Chain (not included)	
600603*	1.0 ft / 30.5 cm
600604**	1.0 ft / 30.5 cm

Cables can be combined for added length \*Nylon covered steel cable (1-6 lbs models)  
\*\*Steel link chain (10-23 lbs models)

TB Dimensions			TBL Dimensions	

## Adjustable Bumpers

Refer to page 26 for cord reel bumpers. Partial List - Visit [Reelcraft.com](http://Reelcraft.com) for a complete list.

When ordering, advise the part number, reel model, and the hose I.D. and O.D. Refer to [Reelcraft.com](http://Reelcraft.com) for dimensions.

**NOTE:** To order hose bumper with stainless steel hardware, change part number from HR to HS (not available with all models).

Part Number	For Reel Series	Hose / Cord O.D.		Hose I.D.		Weight		Overall Diameter	
		in (mm)		in	mm	lbs	kg	in	mm
S1-HR1004-A	4000 / 5000 / RT400 / L4500 / L5000 / DP	.438 (11) - .625 (16)		1/4	6	.24	.10	2 1/2	64
S1-HR1004	4000 / 5000 / RT400 / RT600	.625 (16) - .749 (19)		3/8	10	.25	.11	2 1/2	64
S1-HR1004-3	7000 / 80000 / RT800 / 5000 / D80000 / DP	.625 (16) - .749 (19)		3/8	10	.24	.10	3	73
S2-HR1004-3	5000 / 5005 / 7000 / 80000 / RT800 / DP	.750 (19) - 1.05 (27)		1/2 or 3/8	13 or 10	.23	.10	3	73
S3-HR1004-3	7000 / 80000 / L7000	1.06 (27) - 1.38 (35)		3/4	19	.32	.14	3	73
S8-HR1004-3	TW5000 / TW7000 / TW80000	.530 (13) twin		1/4 twin	6	.24	.10	3	73
S600193	L 4000 / L 5000 / L 7000 / L 70000	.320(8) - .530(14)		---	---	.25	.11	2 1/2	64
S600521	TH80000 / TW80000 / TH7000	.680 (17) twin		3/8 twin	10	.45	.20	3 1/2	89
S600522	TH80000	.810 (21) twin		1/2 twin	13	.49	.22	3 1/2	89
S2-HR1005	E9000	.750 (19) - 1.05 (27)		1/2	13	.95	.43	3 1/2	89
S3-HR1005	E9000 / FE9000 / SD	1.06 (27) - 1.38 (35)		3/4	19	.95	.43	3 1/2	89
S4-HR1005	D80000 / E9000 / FE9000 / SD	1.39 (35) - 1.55 (39)		1	25	.81	.36	3 1/2	89
S600547-1	FE9500 / FF9500	1.55 (39) - 1.75 (44)		1 1/4	32	.70	.31	3 3/4	95
S600547-2	FE9600 / FF9600	1.75 (44) - 2.03 (52)		1 1/2	38	.57	.25	3 3/4	95



## Inlet Hose Assemblies

Partial List - Refer to Reelcraft.com for a complete list

A flexible hose connection must be used between the hose reel inlet and the source of supply to prevent possible misalignment and binding or warranty is void. Please furnish the following information when ordering: part number, product, and pressure to be handled. **NOTE:** Swivel fittings are recommended to protect hose during installation.







Part Number	I.D. in	O.D. in	Length ft	Pressure psi	End Fittings in - NPT(M)	Wgt. lbs
<b>Low Pressure Air/Water Inlet Hoses</b> - PVC nylon braid. Max temp 150°F (65°C)						
S601024-2	3/8	0.600	2	300	3/8 x 3/8	0.9
S601024-4	3/8	0.600	4	300	3/8 x 3/8	1.1
S601024-6	3/8	0.600	6	300	3/8 x 3/8	2.7
S601020-2	1/2	0.750	2	300	1/2 x 1/2	1.2
S601020-4	1/2	0.750	4	300	1/2 x 1/2	1.6
S601020-8	1/2	0.750	8	300	1/2 x 1/2	3.5
S601026-2	3/4	1.075	2	250	3/4 x 3/4	1.4
S601026-7	3/4	1.075	7	250	3/4 x 3/4	3
S601026-10	3/4	1.075	10	250	3/4 x 3/4	4
S601027-2	1	1.375	2	250	3/4 x 1	1.72
S601027-5	1	1.375	5	250	1 x 1	3.25
S600982-10	1	1.375	10	300	1 x 1 NPSH(F)	4.2
<b>Swivel End Fitting - One End</b>						
S601034-3	3/4	1.075	3	300	3/4 x 3/4	2
S601034-4	3/4	1.075	4	300	3/4 x 3/4	2.3
S601034-5	3/4	1.075	5	250	3/4 x 3/4	4
S601034-10	3/4	1.075	10	250	3/4 x 3/4	5
S601027-4	1	1.375	4	250	1 x 1	3.3
<b>Swivel End Fitting - Both Ends</b>						
S601034-2	3/4	1.075	2	300	3/4 x 3/4	1.7
S601026-5	3/4	1.075	5	250	3/4 x 3/4	2.6
S601034-7	3/4	1.075	7	250	3/4 x 3/4	4
<b>Medium Pressure Oil Inlet Hoses</b> 100 R1T one wire braid. Max temp 210°F (99°C)						
S32-260043	3/8	0.710	2	2250	3/8 x 3/8	1
S17-260043	1/2	0.850	2	3000	1/2 x 1/2	1.7
S39-260043	1/2	0.850	5	2000	1/2 x 1/2	3
<b>High Pressure Grease Inlet Hoses</b> 100 R2T two wire braid. Max temp 210°F (99°C)						
S17-260044	1/4	0.58	2	5000	1/4 x 1/4	0.75
S14-260044	3/8	0.73	2	4000	3/8 x 1/2	0.83
<b>Water Inlet Hoses</b> PVC nylon braid with garden hose thread						
S601025-4	1/2	0.750	4	300	1/2 x 3/4	1.5
S601025-6	1/2	0.750	6	300	1/2 x 3/4	2

## Replacement Outlet Hose Assemblies





Partial List - Refer to Reelcraft.com for a complete list

Part Number	I.D. in	O.D. in	Length ft	Pressure psi	End Fittings in - NPT(M)	Wgt. lbs
<b>Low Pressure Air/Water Hoses</b> PVC nylon braid. Max temp 150°F (65°C)						
S601001-25	1/4	0.475	25	300	1/4 x 1/4	3
S601001-50	1/4	0.475	50	300	1/4 x 1/4	5
S601013-25	3/8	0.600	25	300	1/4 x 1/4	4.5
S601013-50	3/8	0.600	50	300	1/4 x 1/4	6
S601012-50	3/8	0.600	50	300	1/4 x 3/8	6
S601017-50	3/8	0.600	50	300	1/4 x 1/2	6
S601017-70	3/8	0.600	70	300	1/4 x 1/2	7.9
S601015-50	3/8	0.600	50	300	3/8 x 1/2	6.5
S601015-75	3/8	0.600	75	300	3/8 x 1/2	8
S601015-100	3/8	0.600	100	300	3/8 x 1/2	14
S601020-25	1/2	0.750	25	300	1/2 x 1/2	5
S601021-50	1/2	0.750	50	300	3/8 x 1/2	8
S601022-50	1/2	0.750	50	300	1/2 x 1/2	9.5
S601022-100	1/2	0.750	100	300	1/2 x 1/2	16
S601026-25	3/4	1.075	25	250	3/4 x 3/4	7.7
S601026-50	3/4	1.075	50	250	3/4 x 3/4	15
S601026-75	3/4	1.075	75	250	3/4 x 3/4	18.75
S601026-100	3/4	1.075	100	250	3/4 x 3/4	22.6
S601027-50	1	1.375	50	250	3/4 x 1	21.8
S601027-100	1	1.375	100	250	3/4 x 1	45
<b>Swivel End Fitting - One End</b>						
S601035-75	1/2	0.750	75	300	1/2 x 1/2	20
S601035-100	1/2	0.750	100	300	1/2 x 1/2	26.4
S601035-200	1/2	0.750	200	300	1/2 x 1/2	53
S601034-25	3/4	1.075	25	250	3/4 x 3/4	8
S601034-50	3/4	1.075	50	250	3/4 x 3/4	15
S601034-75	3/4	1.075	75	250	3/4 x 3/4	23
S601034-100	3/4	1.075	100	250	3/4 x 3/4	31
<b>Medium Pressure Oil Hoses</b> 100 R1T one wire braid. Max temp 210°F (99°C)						
S43-260043	1/4	0.530	50	2750	1/4 x 1/4	7.9
S12-260043	3/8	0.710	25	2250	3/8 x 3/8	6
S46-260043	3/8	0.710	50	2250	3/8 x 3/8	10.2
S5-260043	3/8	0.710	50	2250	3/8 x 1/2	10.4
S8-260043	1/2	0.850	50	3000	1/2 x 1/2	14.1
S24-260043	1/2	0.850	75	3000	1/2 x 1/2	22
S27-260043	3/4	1.120	50	1250	3/4 x 3/4	22.2
S28-260043	3/4	1.120	75	1250	3/4 x 3/4	30
<b>High Pressure Grease Hoses</b> 100 R2T 2 wire braid. Max temp 210°F (99°C)						
S9-260044	1/4	0.580	50	5000	1/4 x 3/8	12.7
S13-260044	3/8	0.730	25	4000	1/4 x 1/4	9.7
S5-260044	3/8	0.730	50	4000	1/4 x 3/8	19.2
S25-260044	3/8	0.730	25	4000	3/8 x 3/8	9.7
S27-260044	3/8	0.730	50	4000	3/8 x 3/8	20.7
S22-260044	3/8	0.730	100	4000	3/8 x 3/8	33
S19-260044	3/8	0.730	50	4000	3/8 x 1/2	20.9
S18-260044	3/8	0.730	75	4000	3/8 x 1/2	26.6
<b>Caution:</b> Be sure working pressure required does not exceed above ratings. Misapplication can result in serious operator injury. <b>Note:</b> Advise product to be handled, maximum temperature and pressure fitting size or sizes when ordering.						

## Motor Kits

Part No.	Specification		Series
<b>Hand Crank/Motor Driven Model Repair Kits</b>			
<b>S602952</b>	Air Motor Gears and Chain Kit		30000
<b>S602953</b>	Air Motor and Bracket Kit		30000
<b>S602957</b>	12 V Motor and Bracket Kit		30000
<b>S602958</b>	Gear and Chain Kit for 12 V Motor		30000
<b>S602959</b>	Gear and Chain Kit for 115 V Motor		30000
<b>S602960</b>	115 V Motor Kit		30000
<b>S602985</b>	12 V Motor Kit		20000

## Additional Accessories









Part No.	Specification		Use with Motor
<b>Circuit Breaker</b>			
<b>S260422</b>	40 AMP, manual reset button must be pressed firmly to reset		S260409 260450
<b>Starting Solenoid</b>			
<b>S260426</b>	12 V DC for activation of motor		S260409 S260583
<b>370018</b>	24 V DC for activation of motor		260450 S260626
<b>Mounting Bracket</b>			
<b>260532</b>	Combination for circuit breaker, solenoid and starting switch		
<b>Chain Shrouds</b>			
<b>S600518</b>	Optional chain shroud for Series 30000 reels.		

## Series 9000 Hose Guide Roller Position Conversion Kits



Part #	For Reel Series
<b>S602907-35</b>	D9000 / E9000 for SW & TW position
<b>S602909-35</b>	D9005 / E9005 for SW & TW position
<b>S602910-35</b>	FF9000 for SW & TW position
<b>S602915-35</b>	G9600 for SW & TW position
<b>S602919-35</b>	G9300 / G9400 for SW & TW position

## Operating Switches

Part No.	Specification		Use with Motor
<b>Momentary Switches</b>			
<b>600811</b>	12/24 V DC, up to 1/3 HP, breaker and relay		S260409
<b>S600808</b>	600811 switch with bracket, 12/24 V DC		S260409
<b>600869</b>	12/24 V DC, up to 2/3 HP		S260626
<b>260424</b>	Momentary contact with rubber cap, 12/24 V DC, non-explosion proof		Any DC motor
<b>Speed Controls</b>			
<b>600866</b>	12/24 V DC		Any DC motor
<b>Momentary Switches with Speed Control</b>			
<b>600873</b>	115/230 V AC, 10 AMP fuse, forward/reverse adjustable speed control		S260430
<b>600867</b>	DC, 25 AMP, up to 1/3 HP		S260409
<b>600868</b>	DC, 40 AMP circuit breaker, up to 2/3 HP		S260583
<b>Air Motor Control Valves</b> (Recommend using a filter, regulator, and lubricator with compressed air motors)			
<b>260454</b>	Pneumatic on/off flow control valve assembly, 1/4" NPTF (F) inlet for 4 AM compressed air motors.		260428

All switches (except 600873) are uni-directional.

## Series 20000 Stacking Bracket Kits

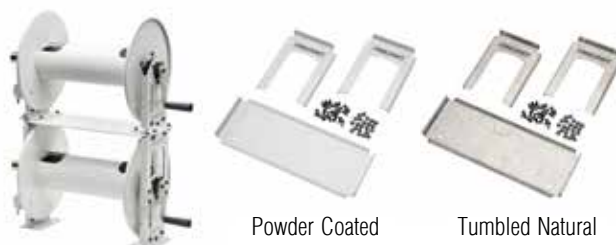

Part #	Spool Size	Finish
<b>S602977-12</b>	12"	Powder Coated
<b>S602977-12</b>	12"	Tumbled Natural
<b>S602977-18</b>	18"	Powder Coated
<b>S602977-18</b>	18"	Tumbled Natural
<b>S602977-22</b>	22"	Powder Coated
<b>S602977-22</b>	22"	Tumbled Natural



HR1057 / HR1059



HR1145



600168

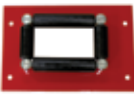

S270109

### Roller Hose Guide Assemblies

Model	Accommodates	Weight		Dimensions							
	Hose O.D.			A		B		C		D	
	in (mm)	lbs	kg	in	mm	in	mm	in	mm	in	mm
HR1057	.603 (16) - .906 (23)	.25	.12	0.875	22.3	N/A		3.125	79.4	3.125	79.4
HR1059	.250 (6.4) - .625 (15.9)	.25	.12	0.625	15.9	N/A		3.125	79.4	3.125	79.4
HR1145	.603 (16) - .906 (23)	.34	.15	2	50.8	1	25.4	3.75	95.3	2.75	69.9
S270109	.900 (23) - 2.00 (50.8)	5.39	2.44	5.25	133.4	2.375	60.4	12	305	8	204
600168	.900 (23) - 1.38 (35)	1.75	.34	1.5	38.1	2	50.8	5.125	130	5.125	130

These four-way roller guide assemblies are for use with reels on cabinet door openings and for similar locations where sharp edges may cut or damage the hose. The four-way design permits pulling or retracting hose at any angle. Model S270109 has nylon rollers mounted on an 11 gauge steel frame with pre-drilled mounting holes.

**Note:** A hose bumper should be used with the four-way roller hose guide assemblies to prevent damage to rollers and nozzles.

### Pivot Bases Not intended for mobile applications.



S600608



600801



600801-12

Part #	Description	For Reel Series	Color
S600608	340° Reel pivot base	RT / 3000 / 4000 / 5000 / 5005 / 7000 / HD70000	Black
600801	340° Reel pivot base	80000 / D80000 / 30006	Black
600801-12	340° Reel pivot base	30012	Black

### Roller Guide Assemblies

Bottom Wind



Three-way rollers



Side Wind



Four-way rollers (multi-position)



### Wall-Mounted Universal Swing Brackets



600626



600992



600993



600980

Part #	Description	For Reel Series	Color
600626	Swing bracket	RT / 4000 / 5000 / 5005 / 7000 / HD70000	Black
600992	Swing bracket	RT	Black
600993	Swing bracket	4000 / 5000	Red
600980	Swing bracket	80000 / D80000 / DP5000 / DP7000	Black



600295



600230

#### Top Mounting Channels and Beam Clamps

600370 - Top channel and beam clamps - for one reel  
 600295 - Top channel and beam clamps - for two reels  
 For mounting Series 7000 reels to an I-beam or overhead support. Mounting channels can be mounted end to end to mount three or more reels. To permit the mounting of Reelcraft Series RT, 4000, 5000, 5005, and electric cord reels on mounting channel, an adaptor assembly must be used (#600230).

#### 600230 Adaptor Assembly

Used with top channels and beam clamps only.

Hose Reel Spool Size		Bottom Wind Roller bracket assembly model number	Side Wind Roller bracket assembly model number	
in	mm			
Series 20000 - Four Way Rollers				
12	305	S602973-12	S602974-12	
18	457	S602973-18	S602974-18	
22	559	S602973-22	S602974-22	
Series 20000 - Four Way Rollers Unfinished				
12	305	S602973-12 310	S602974-12 310	
18	457	S602973-18 310	S602974-18 310	
22	559	S602973-22 310	S602974-22 310	
Hose Reel Spool Size		Bottom Wind Roller bracket assembly model number	Top Wind Roller bracket assembly model number	Multi Position Roller bracket assembly model number
in	mm			
Series 30000 - Four Way Rollers				
6	152	S600693-1	S600692-1	S600533-1
12	305	S600693-2	S600692-2	S600533-2
18	457	S600693-3	S600692-3	S600533-3
Series 30000 - Three Way Rollers				
6	152	S602132-1	S602133-1	
12	305	S602132-2	S602133-2	
18	457	S602132-3	S602133-3	

Bottom wind and top wind may be used with all models except bevel crank. Multi position may not be used on models with a chain guard or Series 37000 reels.

## **Reelcraft Corporate Headquarters**

2842 E. Business Hwy. 30, Columbia City, IN 46725

**Customer Service:** 855-634-9109

Phone: 260-248-8188

**feedback@reelcraft.com | reelcraft.com**



**READY**  
WHEN YOU ARE.